

# Locks



 **NEWSTAR**  
**2014**

# Page Index

# Newstar Product Guide

# 2014

## Page Content

1-2	National Key Scheme Locks and Keys
3	Disabled Toilet Handle Set
4-6	Garage, Shutter Locks, Sash Jammer & Padlocks
7-10	Nightlatches
11-13	Fire Brigade Locks, Padlocks and Keys
14-15	Budget Locks and Keys
16-17	PAS 23/24 Espagnolette Bolts
18-26	DIN Lock Range
27-32	UK British Standard Locks, Lever and Cylinder to BS3621
33-36	UK Housing Type Locks, Latch, Bath, Lever plus all rebates
37-39	Security, Contract and Budget Cylinders
40-43	Front Door Security
44-46	Padlocks
47-50	Cam Locks
51	Specialist Keys
52	Rim Locks and Espagnolettes
53-54	Panic Bolts
55-61	Window Fittings, Restrictors, Catches, Locks and Stays
62	Parking Posts
63	Flush Bolts
64	Locking Bolts, Bars and Security Bolts
65-66	Budget Escutcheons and Lock Components
67-70	Mailboxes, Key Cabinets and Cigarette Bins
71	Safes
72-75	General Ironmongery, Closers, Stops, Handryers.
76-82	Key Blanks
83	Silicone & Adhesives
84	Request a Full Catalogue

## Key to finishes

**BZP** Bright Zinc Plated

**BLK** Black

**BRN** Brown

**CHR** Chrome

**EB** Electro Plated Brass

**FB** Florentine Bronze

**GAL** Galvanised

**GS** Gold Sprayed

**GRE** Green

**GR** Grey

**NP** Nickel Plated

**PL** Plastic

**PA** Polished Aluminium

**PB** Polished Brass

**PCP** Polished Chrome Plated

**PSS** Polished Stainless Steel

**RED** Red

**SAA** Satin Aluminium

**SCP** Satin Chrome Plated

**SNP** Satin Nickel Plated

**SSS** Satin Stainless Steel

**SILV** Silver

**SE** Silver Enamelled

**BRS** Standard Brass

**TR** Transparent

**WHT** White

**YEL** Yellow

**ZP** Zinc Plated

## Key to other symbols

**CE** CE Marked

**FR 30** Fire Rating 30 minutes

**EN** European Norm

**FR 60** Fire Rating 60 minutes

## Contacts

### Sales

**T:** (01474) 353111

**F:** (01474) 353911

**E:** [sales@new-star.co.uk](mailto:sales@new-star.co.uk)

**W:** [new-star.co.uk](http://new-star.co.uk)

## BARYCOMPLETE.RH.SSS

SSS

## BARYCOMPLETE.LH.SSS

The new enhanced NKS lock is now made as standard in Satin Stainless Steel (Grade 316) which is suitable for external use in excessive climatic conditions. The lever handle is a return to door safety type and complies with current DDA regulations. Externally a red and white indicator identifies the toilets current status, there is a built in coin emergency release plus anti-vandal external bolt fixings. All locks come with one standard key to be used for fitting.

## Interchangeable

The NEWSTAR NKS lock can be operated with all current NKS keys on the market. In addition you can retro fit a NEWSTAR NKS lock into any existing mortises without further adjustment.

## Functionality

The lock is operated from the inside via the standard lever operation that retracts the latch. The lever when in the horizontal position can be lifted up to ensure that the latch bolt is locked. When lifted the red indicator shows on the outside, the key will not operate the lock, although emergency access is available via the built in coin emergency release. External access is via key only when white indicator is showing, coin emergency release when indicator is red. Once the door is closed again, it will automatically lock.

### External to operate



Key access  
Coin release

### Internal Standard



Horizontal

### Internal to lock



Lever travel 45°

### Internal to operate



Lever travel 20°

## Handing

The lever furniture is handed but the lock is reversible.



**Right hand** anti clockwise closing



**Left hand** clockwise closing

## BARY.NKS.KEY

The new NKS keys are available from [new-star.co.uk](http://new-star.co.uk) and selected wholesalers. It has been designed to encompass more users and allow ease of use.

### Key features include;

- Extremely tactile
- Bow allows ease of use
- NKS logo
- National Key Scheme (NKS) identification
- Key Ring hole
- Braille identification
- Bright red bow.



# Disabled Toilet Handle Set (dual handed)

# Garage Door Bolt



## Disabled toilet handle set

**NS.DTHS**



- Ideal for retro fitting
- Dual Handed
- Suitable for hinged or sliding doors
- Emergency Release



## Garage Door Bolt c/w Hardened Steel Rollers

**NS.GDB**



- The Newstar **BARRY** garage door bolts are for use on all types of sectional or up and over garage doors. Universally designed this product allows for a wide variation of door constructions, operated from both sides and can be fitted either vertically or horizontally.
- The **BARRY** garage door bolt comes with hardened steel rollers to enhance security.
- The **BARRY** garage door bolt is very easy to fit on all metal or wooden doors up to 38mm thickness.
- They come complete with coach bolts, nuts and escutcheons.
- Both locks are keyed alike with a four sided key offering millions of key differs. Three keys are provided.
- The **BARRY** garage door lock is available in black.

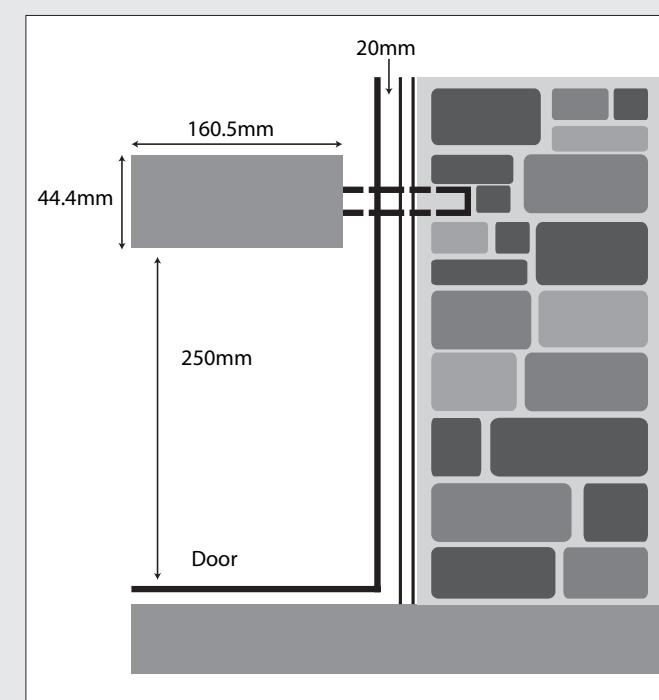



# Sash Jammer, Padlocks & Garage Door Handles

# Shutter Locks

Sash Jammer for  
doors & windows

**NS.SJ1**

Zinc diecast body with  
heavy duty steel hinge



Armour plated shutter  
padlock

**NS.SP1**

5 pin tumbler mechanism  
Brass core with hardened steel  
cover. Hardened steel shackle.  
Supplied with 3 keys.  
Available:  
• keyed to differ  
• keyed alike



Heavy Duty Locking Bar

**NS.LB1**

Malleable cast body  
Forged hardened steel staple  
Supplied with 2 fixing plates  
and 7 fixing bolts



Round Faced Bullet Lock

**NS.CBL1**

Chrome plated brass body,  
steel pin. Available keyed alike  
or in groups of 10.  
Supplied with 2 numbered keys

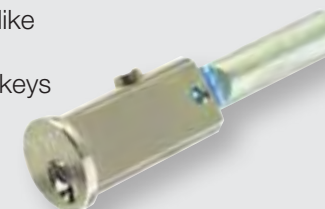

Steel Housing for CBL1 Bullet Lock

**NS.LES1**

Machined from 40mm  
diameter mild steel bar  
Tapered profile, Self colour finish



5 Lever Close Shackle  
Padlock

**NS.CS1**

65mm. Double steel plates  
Hardened steel shackle  
Supplied with 2 keys



Furniture handle

**NS.FH1F** - Front hole fixing

**NS.FH1R** - Rear hole fixing

8mm spindle



Furniture handle

**NS.FH2** - Front hole fixing

76mm spindle



Garage door handle

**NS.GDH1S (Square)**

**NS.GDH1D (Diamond)**

Backplate 75x43mm  
Spigots 17mm



Garage door handle

**NS.GDH2**

Diamond  
Backplate 75x43mm  
Spigots 35mm

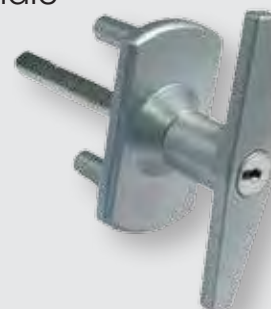

Garage door handle

**NS.GDH3**

Square  
Backplate 120x70mm



Garage door handle

**NS.GDH4**

Square  
100x62mm



Vertical Locking Bar

**NS.LB2**

Mild steel construction with  
hardened steel staple  
Supplied with fixing screws  
and bolts

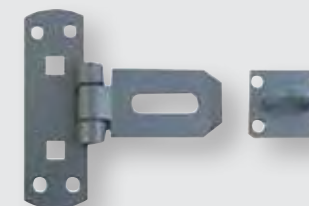

Central shutter lock

**NS.CSL1**

Standard width, case size 155mm x 55mm  
Available keyed alike or in groups of 10  
Key operated from both sides  
Supplied with 3 numbered keys



Oval Bullet Lock

**NS.OBL1**

Brass body, steel pin  
Available keyed alike or in groups of 10  
Supplied with 2 numbered keys

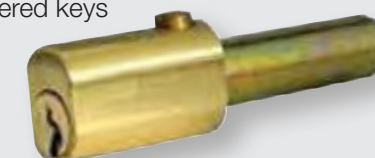

Central shutter lock

**NS.CSL2**

Narrow width, case size 155mm x 40mm  
Available keyed alike or in groups of 10  
Key operated from both sides  
Supplied with 3 numbered keys

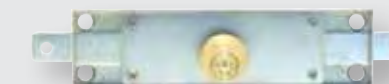

Steel Housing for OBL1 Bullet Lock

**NS.OES1**

Machined from 40mm diameter mild steel bar  
Tapered profile. Self colour finish

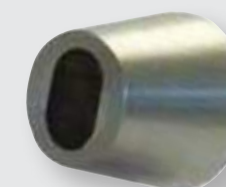

Central shutter lock

**NS.CSL3**

Ultra narrow width, case size 200mm x30mm  
Available keyed alike or in groups of 10  
Key operated from both sides  
Supplied with 2 numbered keys



# Roller bolt night latch C€

# Standard night latch

## Roller bolt night latch case only

**LRB1**

C/W Cylinder **Ref: RB1**



### Functional criteria:

1. Thumb turn handle withdraws and throws roller bolt.
2. Cylinder withdraws and throws roller bolt.
3. Roller bolt holds door in position when unlocked.
4. Meets the recommendations of BS 5588.

### Classification confirmed by Warrington apt

1121-CPD-AQ0017:2005

3	C	8	1	0	F	2	R	A	0	0
---	---	---	---	---	---	---	---	---	---	---

### Fire Tested by Warrington apt

BS 1634-1 2000 30 minutes

### Dimensional Requirements

Suitable for doors from 35mm to 60mm  
Backset 60mm

### BS EN 12209 : 2003 Building Hardware - Mechanically operated locks, latches and locking plates

A comprehensive classification system for assessing the wide range of products needed to satisfy the diverse requirements of the European market. Features assessed include normal use (and abuse) forces, long-term durability, fire/smoke resistance, corrosion and temperature resistance and security, both manipulative and physical.

## Standard night latch case only

**LNL1**

C/W Cylinder **Ref: NL1**



### Functional criteria:

1. Thumb turn handle withdraws and throws latch bolt.
2. Cylinder withdraws and throws latch bolt.

### Fire Tested by Warrington apt

BS 1634-1 2000 30 minutes

### Dimensional Requirements

Suitable for doors from 35mm to 60mm  
Backset 60mm

Note: Latch is not reversible

# Dead bolt night latch

# Budget Night Latch



## Dead bolt night latch case only

**LDL1**

C/W Cylinder **Ref: DL1**



### Functional criteria:

1. Thumb turn handle withdraws and throws dead bolt.
2. Cylinder withdraws and throws dead bolt.

### Fire Tested by Warrington apt

BS 1634-1 2000 30 minutes

### Dimensional Requirements

Suitable for doors from 35mm to 60mm  
Backset 60mm

## Deadlocking (case only)

**BNL1** 60mm Backset

**BNL2** 40mm Backset



### Functional criteria:

1. Thumb turn handle withdraws and throws latch bolt.
2. Cylinder withdraws and throws latch bolt.
3. Snib holds back bolt.
4. Snib dead bolts latch.
5. Double locking feature. 360° anti-clockwise key turn deadlocks handle and bolt.
6. Suitable for doors from 35 to 60mm.

## Standard (case only)

**BNL3** 60mm Backset

**BNL4** 40mm Backset



### Functional criteria:

1. Thumb turn handle withdraws and throws latch bolt.
2. Cylinder withdraws and throws latch bolt.
3. Snib holds back bolt.
4. Snib dead bolts latch.
5. Suitable for doors from 35 to 60mm.

## Rim Cylinder

**RC1**

All c/w 3 keys.





# London Fire Brigade locks

# London Fire Brigade locks

## Mortice Deadlock

**FB1.M**

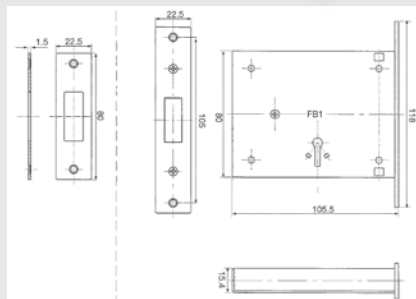

## Mortice Deadlock

**FB2.M**

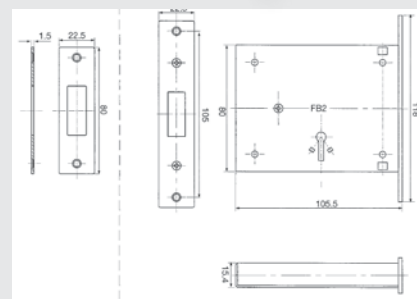

## Rebates

**FB.REBATE.13**

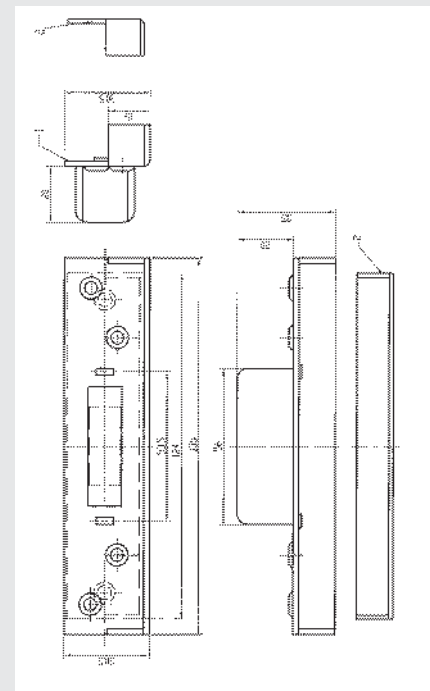

**BZP**

**FBR**

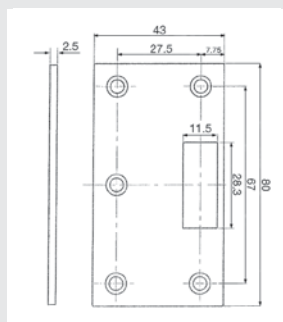
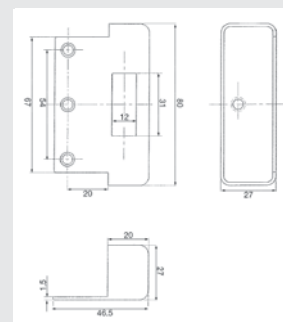

**Patent Pending**

## London Fire Brigade Padlock

**LFB: Padlock**

**LFB.KEY: Keys**



## London Fire Brigade Padlock

**LFB14: Padlock**

**LFB14.KEY: Keys**



## London Fire Brigade Padlock

**LFB11: Padlock**

**LFB.KEY11: Keys**



## Rim Deadlock

**FB1.R**



No need to double your stock, hold the Rim Conversion Kit separately, these are also reversible

## Rim Deadlock

**FB2.R**



**Fire Tested by Warrington apt BS 1634-1 2000**

## Keys

**FB1/FB2 Keys**



## Mortice Strike

**FB.Strike**

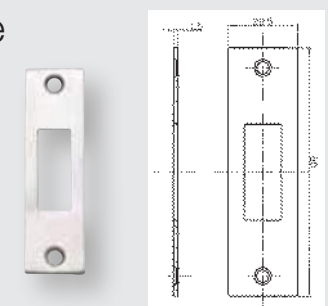

**SSS**



# London Fire Brigade locks

# Budget Lock Range

## Reversible rim slam lock

**FB4**

GR

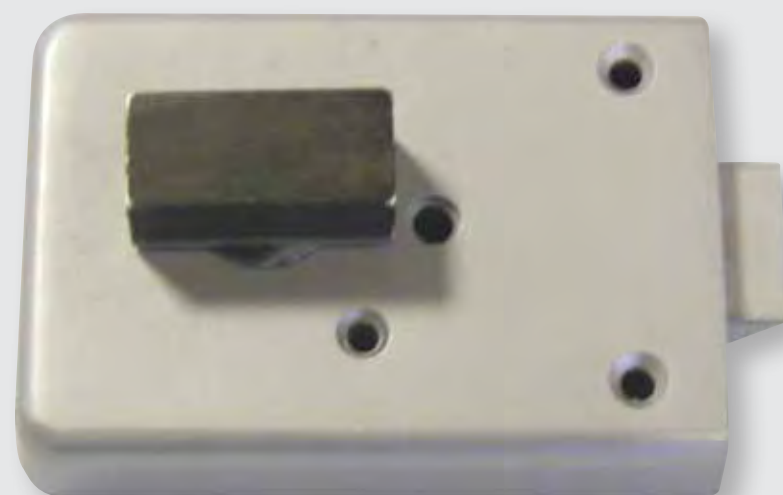

**FB4.KEY**



## Escutcheon

**FB.ESC**

SSS



**FB4.STRIKE**

BZP

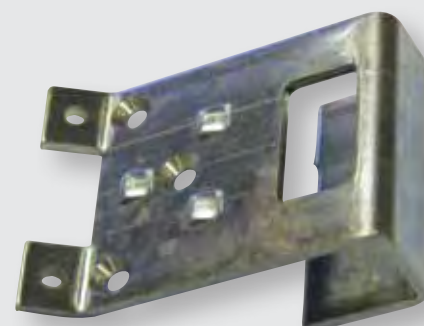

## Mortice Budget Lock

**NS.A**

90 x 19.5 x 25.4mm

FR 30

BZP

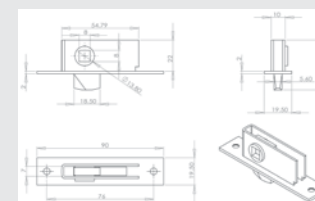

## Budget Lock Flatplate Escutcheon

**NS.B**

50 x 21.2 x 1.5mm  
Ø 13mm

BZP

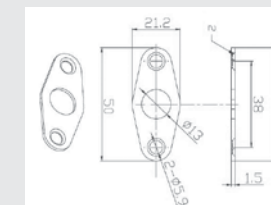

## Mortice Budget Lock Strike

**NS.C**

79 x 16 x 1.5mm

BZP

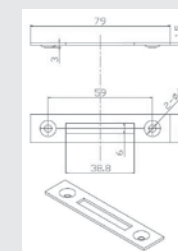

## Budget Lock Ferrule Escutcheon

**NS.E**

13.1 x Ø 17.8mm  
Ø 12.8mm

BZP

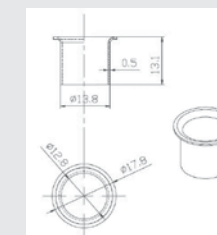

## 'T' Key

**NS.F**

118 x 80mm  
Ø 9.5mm

BZP

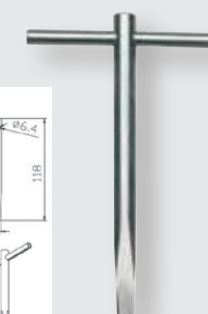
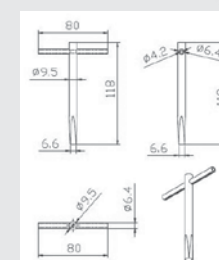

## Sprung Escutcheon

**NS.L**

5.9mm  
Ø 28mm

SSS

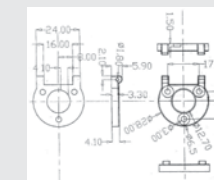

## Rim Budget Lock

**NS.H**

80 x 20 x 11.2mm

BZP

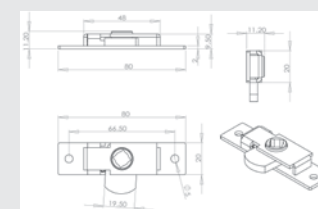

## Rim Budget Lock Strike

**NS.G**

76.7 x 18.3 x 10mm

BZP

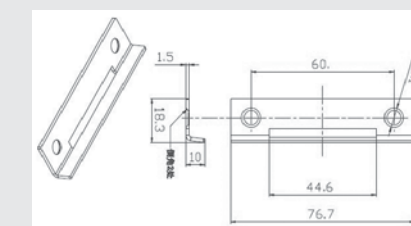

# Rim captive key budget lock

# Grid Ace Series PAS 24

## Functions:

Key only withdraws from lock when in locked position



## Rim Captive Key Budget Lock

BZP

### NS.N

90 x 25.4 x 30.5mm  
Ø 16mm

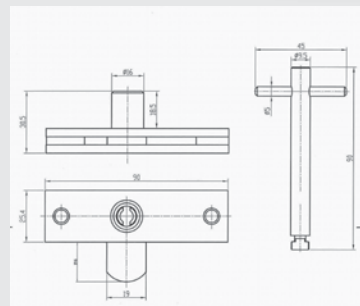
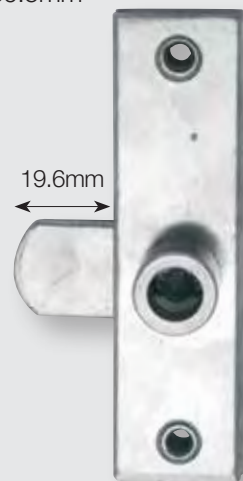

## Budget Lock Ferrule Escutcheon

SSS

### NS.K

Ø 20mm

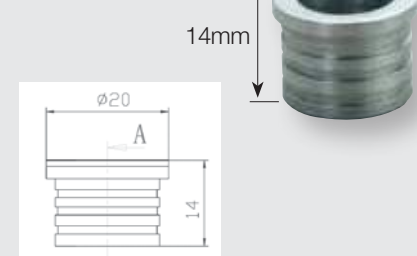

## Budget Lock Covered Ferrule Escutcheon

SSS

### NS.CK

Ø 20mm  
15mm

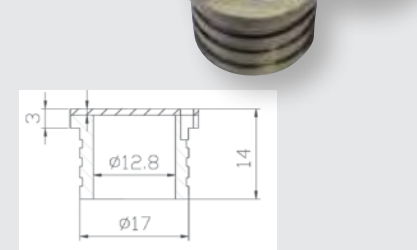

## Captive Key

BZP

### NS.P

90 x 45mm  
Ø 9.5mm

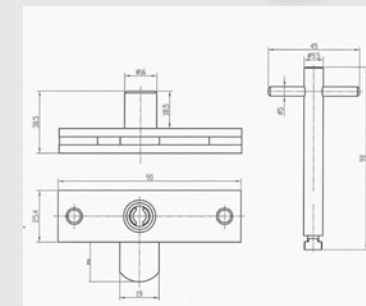

## Multipoint Lock

### REF: GA1

- British designed to the latest European specifications.
- Passed the loading tests of PAS 24.
- Performed over 50,000 cycles.
- Successfully assessed in a fire resistant doorset to EN1634-1:2000 (30 minute).
- Patented 20mm bolt throw with lift lever action and one turn of the key (Pat 0322874.9).
- Adjustable metal box keeps.

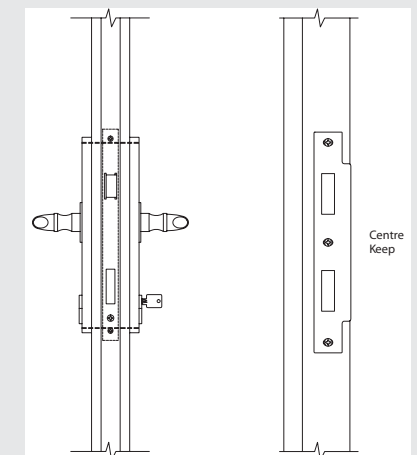
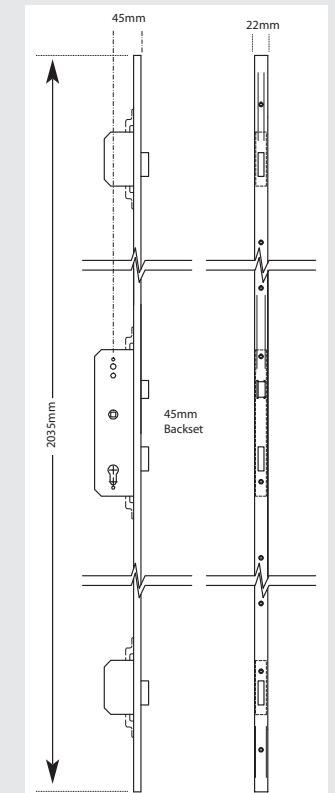

## Multipoint Lock

**REF: GA2**

- British designed to the latest European specifications.
- Included in a security doorset tested to PAS 23 and PAS 24.
- Included in a fire resistant doorset tested to EN1634-1:2000 (Chilt RF02046A).
- Patented 20mm bolt throw with lift lever action and one turn of the key (Pat 0322874.9).
- Adjustable metal box keeps.
- Entry can be gained from either side of the door when unlocked.

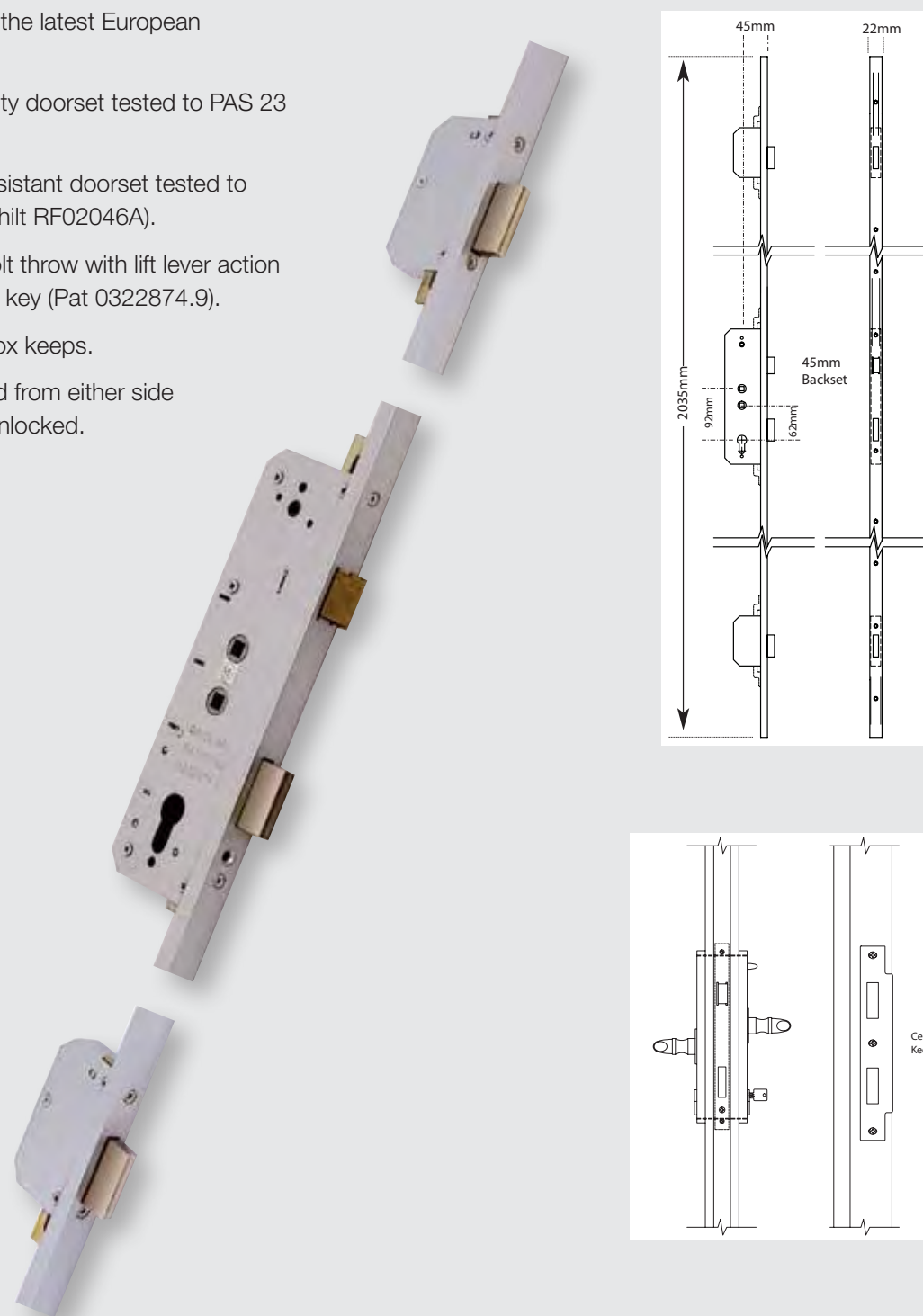

SE

## Split follower escape sash lock

**ESL1**



FR 60

SE

**Classification confirmed by Warrington apt**

1121-CPD-AQ0017:2005

3	7	6	1	1	3	4	2	A
---	---	---	---	---	---	---	---	---

BS EN 179:1998 & A1:2001

**Fire Tested by Warrington apt**

BS 1634-1 2000 & BS 476 Part 22. 60 minutes

**Dimensional Requirements**

DIN 18251

**Additional requirements**

Split follower spindle Ref: NS.SS

13mm & 25mm rebates available.

Intumescent pack available.

**BS EN 179 - Emergency exit devices**

This standard covers devices to be used in emergency situations where people are familiar with the emergency exit and its hardware and therefore a panic situation is most unlikely to develop. Lever handle operated escape mortice locks or push pads may therefore be used.

Note: When using a cylinder and turn, if the cam is not fully turned then the lock may jam. We recommend a double cylinder is used with this lock.

**Functional criteria:**

1. Lever handle withdraws and dead bolt.
2. Latch bolt is reversible for opening in or out.
3. Split follower function is handed.
4. Cylinder double throws dead bolt to 22mm.
5. Cylinder withdraws latch.
6. 60mm backset. 72mm centres.
7. Strike includes dust caps in white.
8. Radius or square forend available.

## Handing

**Right hand** anti clockwise closing



**Left hand** clockwise closing





# DIN Escape lock range C€

# DIN Escape lock range C€

## Escape dead lock case

EDL1



### Functional criteria:

1. Lever handle withdraws dead bolt.
2. Cylinder double throws dead bolt to 22mm.
3. 60mm backset. 72mm centres.
4. Strike includes dust caps in white.
5. Radius or square forend available.

### Classification confirmed by Warrington apt

1121-CPD-AQ0017:2005

3	6	6	1	1	3	4	2	A
---	---	---	---	---	---	---	---	---

BS EN 179:1998 & A1:2001

### Fire Tested by Warrington apt

BS 1634-1 2000 & BS 476 Part 22

### Dimensional Requirements

DIN 18251

Note: We do not recommend you use cylinder and turns with this lock case.

### Additional requirements

Tested lever handle available. AG-006

13mm & 25mm rebates available.

Intumescent pack available

### BS EN 179 - Emergency exit devices

This standard covers devices to be used in emergency situations where people are familiar with the emergency exit and its hardware and therefore a panic situation is most unlikely to develop. Lever handle operated escape mortice locks or push pads may therefore be used.

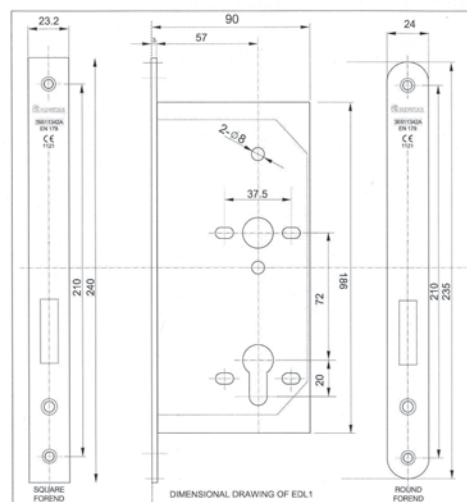

## Split follower classroom lock case

SFCL1



### Functional criteria:

1. Lever handle withdraws latch bolt, one side fixed dead opposite side.
2. Latch bolt is reversible.
3. Split follower reversible.
4. Cylinder withdraws latch.
5. 60mm backset. 72mm centres.
6. Strike includes dust caps in white.
7. Radius or square forend available

### Classification confirmed by Warrington apt

1121-CPD-AQ0017:2005

2	W	8	1	0	F	-	B	A	2	0
---	---	---	---	---	---	---	---	---	---	---

### Fire Tested by Warrington apt

BS 1634-1 2000 & BS 476 Part 22 60 minutes

### Dimensional Requirements

Meets the dimensional requirements of BS 8300 DIN 18251

### Additional requirements

Split follower spindle Ref: NS.SS

13mm & 25mm rebates available.

Intumescent pack available.

### BS EN 12209 : 2003 Building Hardware - Mechanically operated locks, latches and locking plates

A comprehensive classification system for assessing the wide range of products needed to satisfy the diverse requirements of the European market. Features assessed include normal use (and abuse) forces, long-term durability, fire/smoke resistance, corrosion and temperature resistance and security, both manipulative and physical.

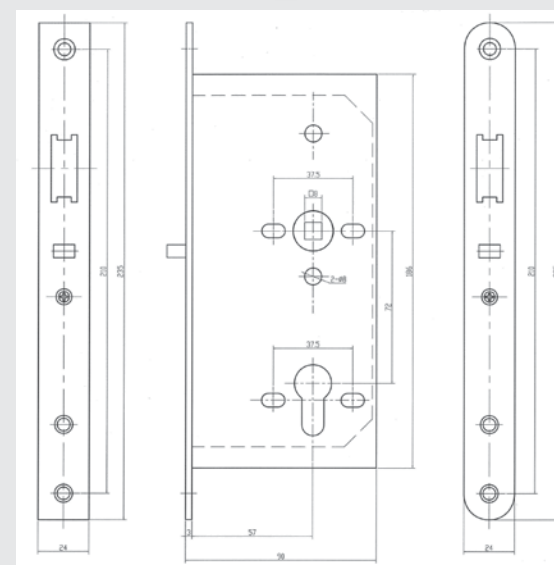

## Sash lock case (Interchangeable forends)

SL1



### Functional criteria:

1. Lever handle withdraws latch bolt.
2. Latch bolt is reversible.
3. Cylinder double throws dead bolt to 22mm.
4. Cylinder withdraws latch.
5. 60mm backset. 72mm centres.
6. Strike includes dust caps in white.
7. Radius or square forend interchangeable available

### Classification confirmed by

#### Warrington apt

1121-CPD-AQ0017:2005

2	X	8	1	0	F	2	B	A	2	0
---	---	---	---	---	---	---	---	---	---	---

BS EN 12209:2003

#### Fire Tested by Warrington apt

BS 1634-1 2000 & BS 476 Part 22 60 Minutes

### Dimensional Requirements

Meets the dimensional requirements of BS 8300  
DIN 18251

### Additional requirements

13mm & 25mm rebates available.  
Intumescent pack available

### BS EN 12209 : 2003 Building Hardware - Mechanically operated locks, latches and locking plates

A comprehensive classification system for assessing the wide range of products needed to satisfy the diverse requirements of the European market. Features assessed include normal use (and abuse) forces, long-term durability, fire/smoke resistance, corrosion and temperature resistance and security, both manipulative and physical.

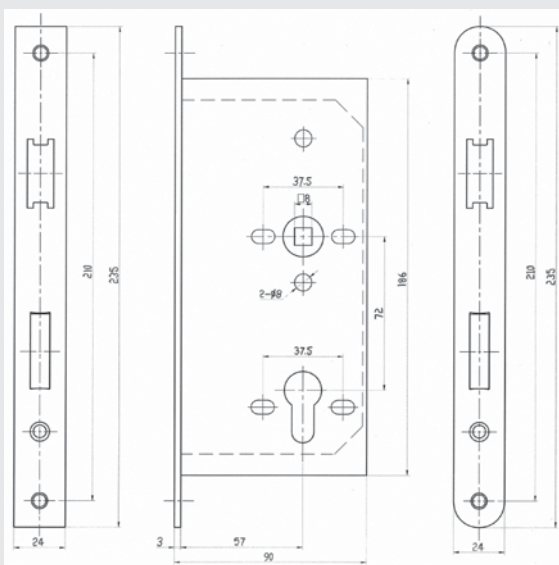

## Dead lock case (Interchangeable forends)

DL1

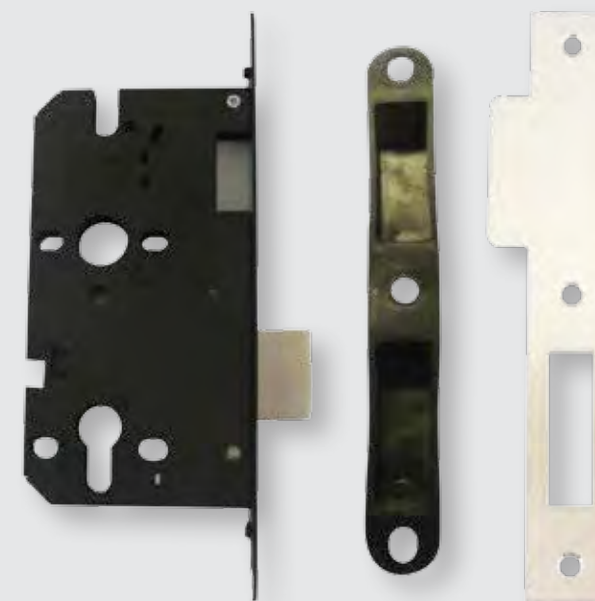

### Functional criteria:

1. Cylinder double throws dead bolt to 22mm
2. 60mm backset.
3. Strike includes dust caps in white.
4. Radius or square forend interchangeable available.

### Classification confirmed by Warrington apt

1121-CPD-AQ0017:2005

3	X	8	1	0	F	2	B	C	0	0
---	---	---	---	---	---	---	---	---	---	---

#### Fire Tested by Warrington apt

BS 1634-1 2000 & BS 476 Part 22 60 minutes

### Dimensional Requirements

DIN 18251

### Additional requirements

13mm & 25mm rebates available.  
Intumescent pack available

### BS EN 12209 : 2003 Building Hardware - Mechanically operated locks, latches and locking plates

A comprehensive classification system for assessing the wide range of products needed to satisfy the diverse requirements of the European market. Features assessed include normal use (and abuse) forces, long-term durability, fire/smoke resistance, corrosion and temperature resistance and security, both manipulative and physical.

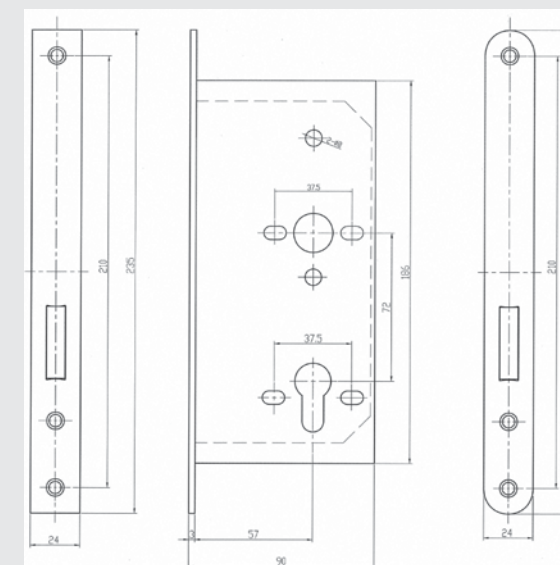

## Bath lock case (Interchangeable forends)

BL1

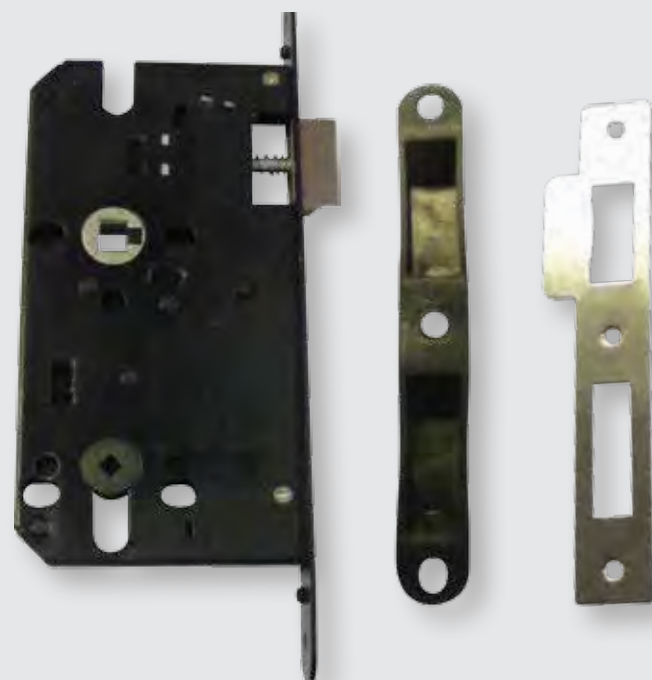

### Functional criteria:

1. Lever handle withdraws latch bolt.
2. Latch bolt is reversible.
3. Thumb turn throws single turn dead bolt 11mm
4. 60mm backset. 72mm centres. 5mm follower.
5. Strike includes dust caps in white.
6. Radius or square forend available.

### Classification confirmed by Warrington apt

1121-CPD-AQ0017:2005

2	X	8	1	0	F	-	B	G	2	0
---	---	---	---	---	---	---	---	---	---	---

### Fire Tested by Warrington apt

BS 1634-1 2000 & BS 476 Part 22 60 minutes

### Dimensional Requirements

Meets the dimensional requirements of BS 8300  
DIN 18251

### Additional requirements

13mm & 25mm rebates available.  
Intumescent pack available.

### BS EN 12209 : 2003 Building Hardware - Mechanically operated locks, latches and locking plates

A comprehensive classification system for assessing the wide range of products needed to satisfy the diverse requirements of the European market. Features assessed include normal use (and abuse) forces, long-term durability, fire/smoke resistance, corrosion and temperature resistance and security, both manipulative and physical.

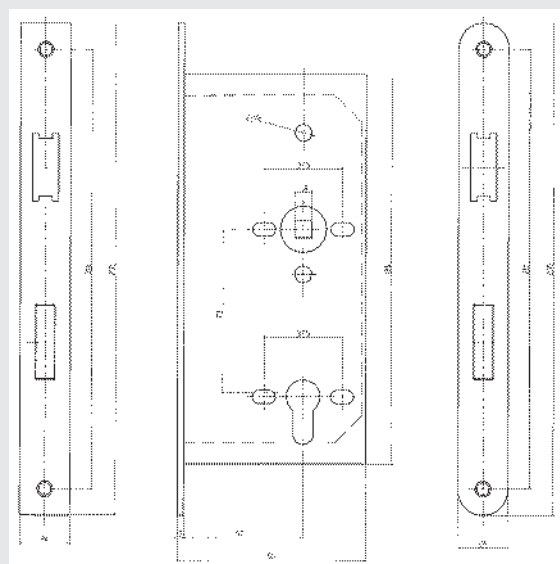

## Latch case (Interchangeable forends)

LL1



### Functional criteria:

1. Lever handle withdraws latch bolt.
2. Latch bolt is reversible.
3. Cylinder withdraws latch.
4. 60mm backset. 72mm centres.
5. Strike includes dust caps in black.
6. Radius or square forend available.

### Classification confirmed by Warrington apt

1121-CPD-AQ0017:2005

2	X	8	1	0	F	-	B	0	2	0
---	---	---	---	---	---	---	---	---	---	---

### Fire Tested by Warrington apt

BS 1634-1 2000 & BS 476 Part 22 60 minutes

### Dimensional Requirements

Meets the dimensional requirements of BS 8300  
DIN 18251

### Additional requirements

13mm & 25mm rebates available.  
Intumescent pack available

### BS EN 12209 : 2003 Building Hardware - Mechanically operated locks, latches and locking plates

A comprehensive classification system for assessing the wide range of products needed to satisfy the diverse requirements of the European market. Features assessed include normal use (and abuse) forces, long-term durability, fire/smoke resistance, corrosion and temperature resistance and security, both manipulative and physical.

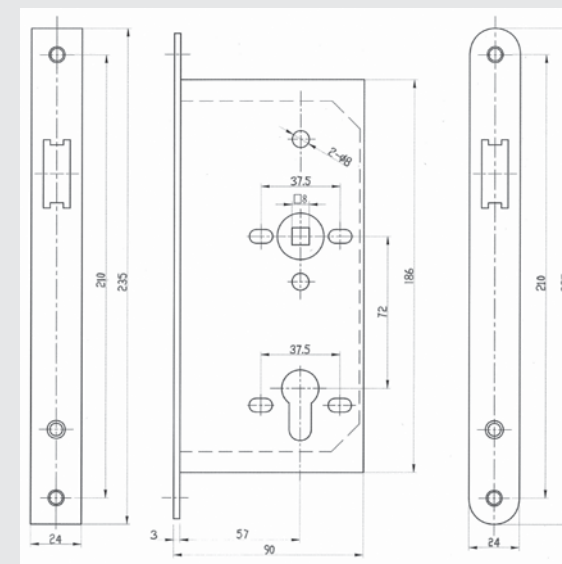

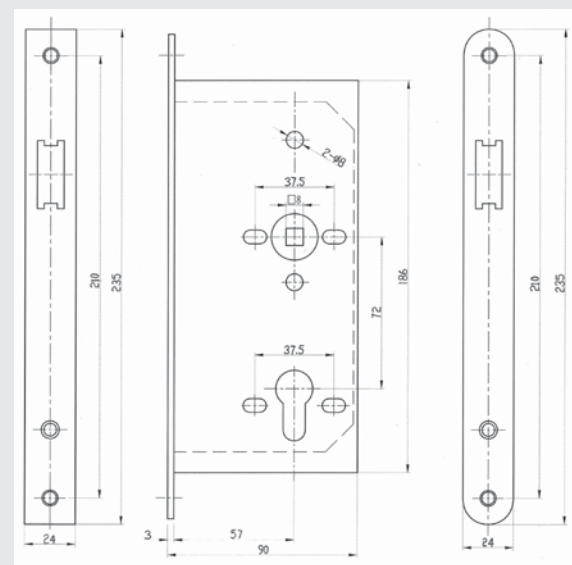
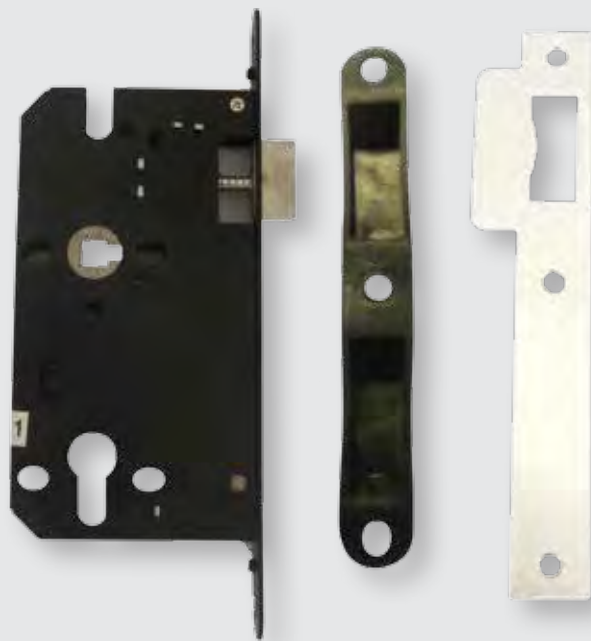

## Night latch case (Interchangeable forends)

**NL1**

**Functional criteria:**

- 1.** Lever handle withdraws latch bolt.
- 2.** Latch bolt is reversible.
- 3.** Cylinder withdraws latch.
- 4.** 60mm backset. 72mm centres.
- 5.** Strike includes dust caps in black.
- 6.** Radius or square forend available.

### Classification confirmed by Warrington apt

1121-CPD-AQ0017:2005

2	X	8	1	0	F	-	B	0	2	0
---	---	---	---	---	---	---	---	---	---	---

## Fire Tested by Warrington apt

BS 1634-1 2000 &amp; BS 476 Part 22 60 minutes

## Dimensional Requirements

Meets the dimensional requirements of BS 8300  
DIN 18251

### Additional requirements

13mm & 25mm rebates available.

Intumescent pack available

**BS EN 12209 : 2003 Building Hardware -  
Mechanically operated locks, latches  
and locking plates**

A comprehensive classification system for assessing the wide range of products needed to satisfy the diverse requirements of the European market. Features assessed include normal use (and abuse) forces, long-term durability, fire/smoke resistance, corrosion and temperature resistance and security, both manipulative and physical.

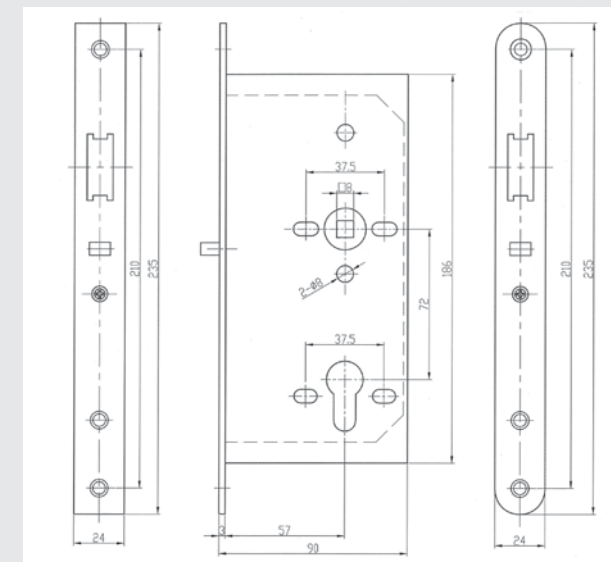
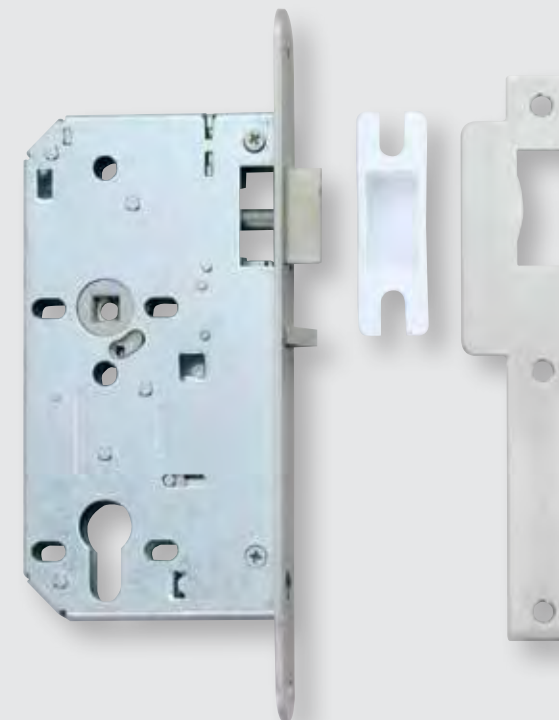

## Night latch c/w anti thrust bolt

**NL1.AT**

**Functional criteria:**

- 1.** Lever handle withdraws bolt.
- 2.** Cylinder withdraws latch bolt.
- 3.** Anti thrust bolt locks latch.
- 4.** 60mm backset. 72mm centres.
- 5.** Strike includes dust caps in white.
- 6.** Radius or square forend available.

### Classification confirmed by Warrington apt

1121-CPD-AQ0017:2005

3	F	8	1	0	F	-	B	B	2	0
---	---	---	---	---	---	---	---	---	---	---

### Fire Tested by Warrington apt

BS 1634-1 2000 & BS476 Part 22 60 minutes

## Dimensional Requirements

Meets the dimensional requirements of BS 8300  
DIN 18251

### Additional requirements

13mm & 25mm rebates available.

Intumescent pack available.

**BS EN 12209 : 2003 Building Hardware -  
Mechanically operated locks, latches  
and locking plates**

A comprehensive classification system for assessing the wide range of products needed to satisfy the diverse requirements of the European market. Features assessed include normal use (and abuse) forces, long-term durability, fire/smoke resistance, corrosion and temperature resistance and security, both manipulative and physical.



# British Standard UK lock range

# British Standard UK lock range

## 5 lever sash lock

**BSSL** BS EN3621:2007



### Functional criteria:

1. Lever Handle withdraws bolt.
2. Key withdraws dead bolt.
3. Reversible Latch bolt
4. 1500 Differs
5. Case 64mm or 76mm

### Classification confirmed BS EN 12209:2003

2	X	5	0	0	F	7	K	D	0	B
---	---	---	---	---	---	---	---	---	---	---

### Fire Tested by Warrington apt BS 1634-1 2000

### Additional requirements 13mm & 25mm rebates available.

### BS EN 12209 : 2003 Building Hardware - Mechanically operated locks, latches and locking plates

A comprehensive classification system for assessing the wide range of products needed to satisfy the diverse requirements of the European market. Features assessed include normal use (and abuse) forces, long-term durability, fire/smoke resistance, corrosion and temperature resistance and security, both manipulative and physical.

Code	Case Dimensions	Backset	Centres	Dead Bolt Projection	Forend Dimensions
BSSL 64mm	64x108x19mm	44.5mm	57mm	20mm	25x156x4.7mm
BSSL 76mm	76x108x19mm	57mm	57mm	20mm	25x156x4.7mm

## 5 lever dead lock

**BSDL** BS EN3621:2007



### Functional criteria:

1. Key withdraws dead bolt.
2. 1500 Differs
3. Case 64mm or 76mm

### Classification confirmed BS EN 12209:2003

2	X	5	0	0	F	7	K	D	2	B
---	---	---	---	---	---	---	---	---	---	---

### Fire Tested by Warrington apt BS 1634-1 2000

### Additional requirements 13mm & 25mm rebates available.

### BS EN 12209 : 2003 Building Hardware - Mechanically operated locks, latches and locking plates

A comprehensive classification system for assessing the wide range of products needed to satisfy the diverse requirements of the European market. Features assessed include normal use (and abuse) forces, long-term durability, fire/smoke resistance, corrosion and temperature resistance and security, both manipulative and physical.

Code	Case Dimensions	Backset	Centres	Dead Bolt Projection	Forend Dimensions
BSDL 64mm	64x80x19mm	44.5mm	n/a	20mm	25x127x4.7mm
BSDL 76mm	76x80x19mm	57mm	n/a	20mm	25x127x4.7mm

Cylinder & turn sash lock

BSSCT BS EN8621:2007



Functional criteria:

- 1. Lever Handle withdraws bolt.
- 2. Key withdraws dead bolt.
- 3. Reversible Latch bolt
- 4. 30,000 Differs
- 5. Case 64mm or 76mm
- 6. Security escutcheons included.

Classification confirmed  
BS EN 12209:2003

2	X	5	0	0	F	7	K	A	2	0
---	---	---	---	---	---	---	---	---	---	---

Fire Tested by Warrington apt  
BS 1634-1 2000

Cylinder  
BS EN 1303:2005

Additional requirements  
13mm & 25mm rebates available.

BS EN 12209 : 2003 Building Hardware -  
Mechanically operated locks, latches  
and locking plates

A comprehensive classification system for assessing the wide range of products needed to satisfy the diverse requirements of the European market. Features assessed include normal use (and abuse) forces, long-term durability, fire/smoke resistance, corrosion and temperature resistance and security, both manipulative and physical.

Code	Case Dimensions	Backset	Centres	Dead Bolt Projection	Forend Dimensions
BSSCT 64mm	64x108x19mm	44.5mm	47.5mm	20mm	25x156x4.7mm
BSSCT 76mm	76x108x19mm	57mm	47.5mm	20mm	25x156x4.7mm

Cylinder & turn dead lock

BSDCT BS EN8621:2007



Functional criteria:

- 1. Key or Turn withdraws dead bolt.
- 2. 30,000 Differs
- 3. Case 64mm or 76mm
- 4. Security escutcheons included.

Classification confirmed  
BS EN 12209:2003

2	X	5	0	0	F	7	B	A	0	0
---	---	---	---	---	---	---	---	---	---	---

Fire Tested by Warrington apt  
BS 1634-1 2000

Cylinder  
BS EN 1303:2005

Additional requirements  
13mm & 25mm rebates available.

BS EN 12209 : 2003 Building Hardware -  
Mechanically operated locks, latches  
and locking plates

A comprehensive classification system for assessing the wide range of products needed to satisfy the diverse requirements of the European market. Features assessed include normal use (and abuse) forces, long-term durability, fire/smoke resistance, corrosion and temperature resistance and security, both manipulative and physical.

Code	Case Dimensions	Backset	Centres	Dead Bolt Projection	Forend Dimensions
BSDCT 64mm	64x80x19mm	44.5mm	n/a	20mm	25x127x4.7mm
BSDCT 76mm	76x80x19mm	57mm	n/a	20mm	25x127x4.7mm



British Standard UK lock range

British Standard UK lock range

Cylinder sash lock

BSSC BS EN3621:2007



Functional criteria:

- 1. Lever Handle withdraws bolt.
- 2. Key withdraws dead bolt.
- 3. Reversible Latch bolt
- 4. 30,000 Differs
- 5. Case 64mm or 76mm
- 6. Security escutcheons included.

Classification confirmed  
BS EN 12209:2003

2	X	5	0	0	F	7	K	A	2	0
---	---	---	---	---	---	---	---	---	---	---

Fire Tested by Warrington apt  
BS 1634-1 2000

Cylinder  
BS EN 1303:2005

Additional requirements  
13mm & 25mm rebates available.

BS EN 12209 : 2003 Building Hardware - Mechanically operated locks, latches and locking plates

A comprehensive classification system for assessing the wide range of products needed to satisfy the diverse requirements of the European market. Features assessed include normal use (and abuse) forces, long-term durability, fire/smoke resistance, corrosion and temperature resistance and security, both manipulative and physical.

Code	Case Dimensions	Backset	Centres	Dead Bolt Projection	Forend Dimensions
BSSC 64mm	64x108x19mm	44.5mm	47.5mm	20mm	25x156x4.7mm
BSSC 76mm	76x108x19mm	57mm	47.5mm	20mm	25x156x4.7mm

Cylinder dead lock

BSDC BS EN3621:2007



Functional criteria:

- 1. Key withdraws dead bolt.
- 2. 30,000 Differs
- 3. Case 64mm or 76mm
- 4. Security escutcheons included.
- 5. 3 Keys Supplied.

Classification confirmed  
BS EN 12209:2003

2	X	5	0	0	F	7	K	A	0	0
---	---	---	---	---	---	---	---	---	---	---

Fire Tested by Warrington apt  
BS 1634-1 2000

Cylinder  
BS EN 1303:2005

Additional requirements  
13mm & 25mm rebates available.

BS EN 12209 : 2003 Building Hardware - Mechanically operated locks, latches and locking plates

A comprehensive classification system for assessing the wide range of products needed to satisfy the diverse requirements of the European market. Features assessed include normal use (and abuse) forces, long-term durability, fire/smoke resistance, corrosion and temperature resistance and security, both manipulative and physical.

Code	Case Dimensions	Backset	Centres	Dead Bolt Projection	Forend Dimensions
BSDC 64mm	64x80x19mm	44.5mm	n/a	20mm	25x127x4.7mm
BSDC 76mm	76x80x19mm	57mm	n/a	20mm	25x127x4.7mm

## Mortice Latch

PB SSS EN CE FR 60

**G1: Square forend & strike**

**G1R: Radius forend & strike**

Size (mm)	65	75	90
A	65	75	90
B	45	55	65

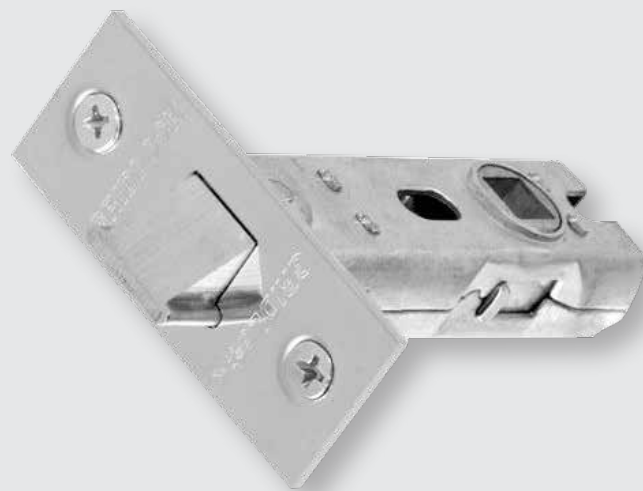
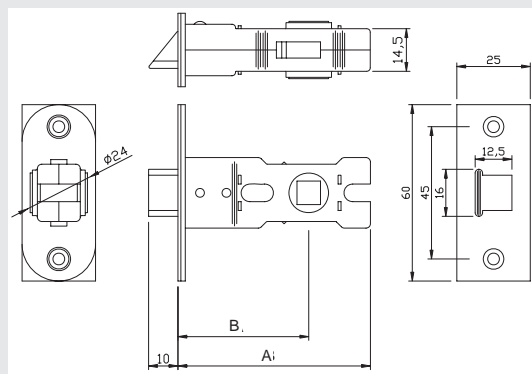

## Upright Latch

PB SSS EN CE FR 60

**G3: Square forend**

**G3R: Radius forend**

Size (mm)	65	75	100
A	65	75	100
B	47	57	67

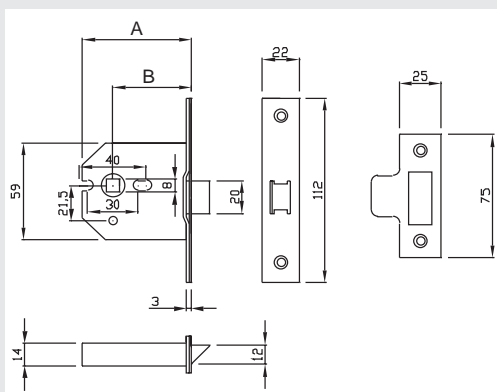

## 3 Lever Mortice Sash Lock

PB SSS EN CE FR 60

**G5: Square forend & strike**

**G5R: Radius forend & strike**

Size (mm)	65	75
A	65	75
B	47	57

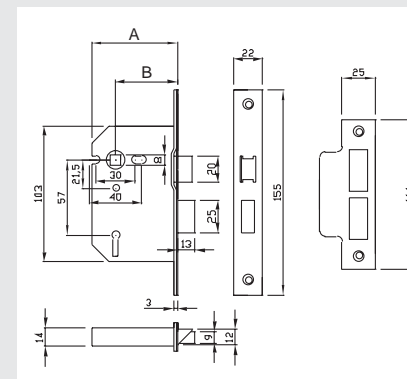

## Euro Profile Sashlock Case

PB SSS EN CE FR 60

**G8: Square forend & strike**

**G8R: Radius forend & strike**

Size (mm)	65	75
A	65	75
B	47	57

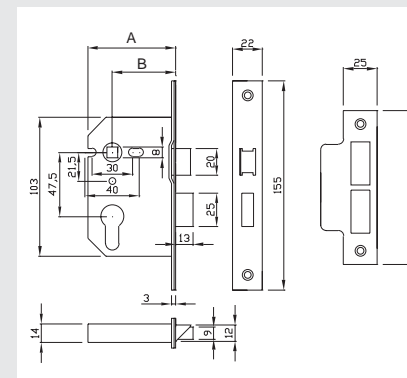

## Oval Profile Sashlock Case

PB SSS EN CE FR 60

**G13: Square forend & strike**

**G13R: Radius forend & strike**

Size (mm)	65	75
A	65	75
B	47	57

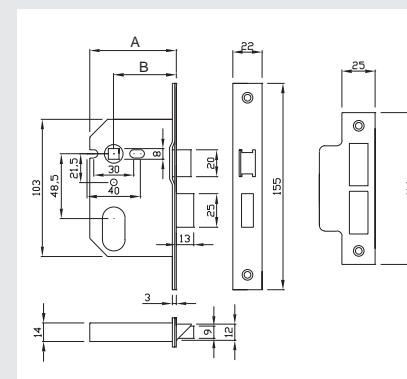





• Anti-bump	• Anti-drill	• Anti-pick	• 10 year guarantee	• 6 Pin 3 Keys	• EN1303
-------------	--------------	-------------	---------------------	----------------	----------

## SS.CD – Double Cylinder

## SS.CT – Cylinder & Turn

### Specifications

- ✓ Complies with EN1303 and kitemarked by BSi, and meets 1\* rating of TS007:2011
- ✓ Includes a sever point that is designed to snap off before the cam when attacked, leaving the lock secure
- ✓ Minimum of 100,000 differs
- ✓ Tested to 100,000 cycles for durability
- ✓ Drill resistance tested
- ✓ Corrosion tested to 96 hours salt spray
- ✓ Available as double, and cylinders with thumbturn
- ✓ 35/35 size available from stock, other sizes available on request.
- ✓ Supplied with 3 keys per cylinder as standard
- ✓ Available in brass and nickel finishes



Please note that this cylinder must not project more than 3mm from the face of the escutcheon or the backplate

### Sizes Available

Sizes	Key/Key PB	Key/Key SCP	Key/Turn PB	Key/Turn SCP	Sizes	Key/Key PB	Key/Key SCP	Key/Turn PB	Key/Turn SCP
35x35	x	x	x	x	40x50	x	x		
35x40	x	x			40x55	x	x		
35x45	x	x			40x60	x	x		
35x50	x	x			45x45	x	x	x	x
35x55	x	x			45x50	x	x		
40x40	x	x	x	x	45x55	x	x		
40x45	x	x							

X = Available from stock SCP = Satin Chrome finish PB = Polished Brass

## Euro Profile Cylinder Range (6 Pin Key Both Sides)

NP PB

• 6 Pin	• 3 Keys	• 10 year guarantee
• Anti-pick	• Pinning Kit Available	• Large Range of Sizes
• Anti-drill	• Available Master Keyed or Keyed alike	• C/W Cylinder Retaining Screws

Code	MM	Product	Keys	Packed	Boxed
C.CD	70mm	Double Cylinder 35x35	3	Box	10
C.CD	80mm	Double Cylinder 35x45	3	Box	10
C.CD	80mm	Double Cylinder 40x40	3	Box	10
C.CD	90mm	Double Cylinder 40x50	3	Box	10
C.CD	85mm	Double Cylinder 40x45	3	Box	10
C.CD	90mm	Double Cylinder 45x45	3	Box	10
C.CD	85mm	Double Cylinder 45x50	3	Box	10
C.CD	100mm	Double Cylinder 45x55	3	Box	10
C.CD	100mm	Double Cylinder 50x50	3	Box	10
C.CT	70mm	Single Cylinder with Thumbturn 35x35	3	Box	10
C.CT	80mm	Single Cylinder with Thumbturn 40x40	3	Box	10
C.CT	90mm	Single Cylinder with Thumbturn 40x50	3	Box	10
C.CT	90mm	Single Cylinder with Thumbturn 45x45	3	Box	10
C.CT	100mm	Single Cylinder with Thumbturn 50x50	3	Box	10

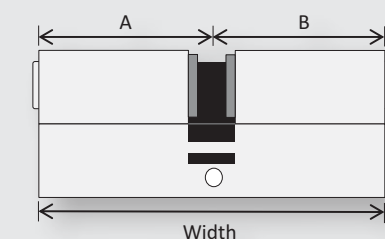

Measurements from each end of centre of cam  
i.e. 30/10/30 is measured 35/35

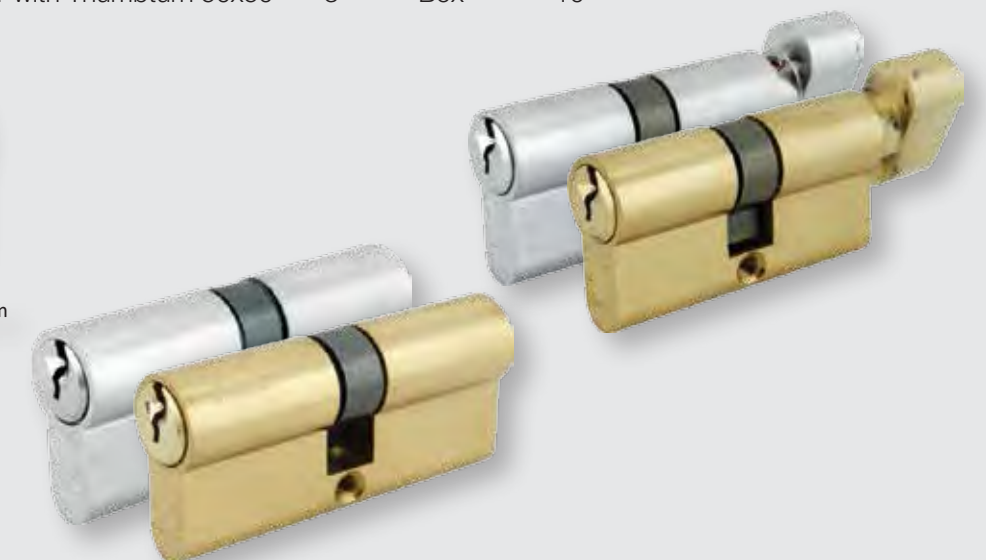

## Euro Profile Half Cylinder Range (6 Pin)

Code	MM	Available Finish	Product	Keys	Packed	Boxed
C.H	40	NP / PB	Half Cylinder 10x30	3	Box	10
C.H	45	NP / PB	Half Cylinder 10x35	3	Box	10
C.H	50	NP	Half Cylinder 10x40	3	Box	10
C.H	55	NP / PB	Half Cylinder 10x45	3	Box	10
C.H	60	NP	Half Cylinder 10x50	3	Box	10
C.H	70	NP	Half Cylinder 10x60	3	Box	10



NP PB

## Euro Half Specials (Adjustable cam)

Code	MM	Product	Packed	Boxed
C.HS	40	Half Specials 10x30	Box	10
C.HS	45	Half Specials 10x35	Box	10

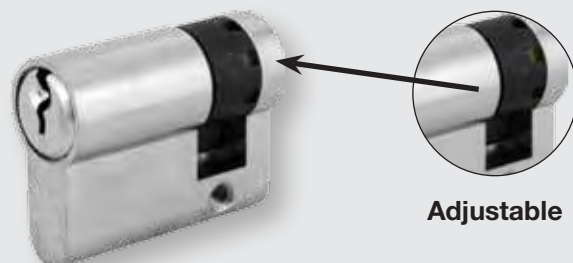

NP

## Blind Thumb Turns

Code	MM	Product	Packed	Boxed
C.HST	45	Euro single cylinder with thumb turn 10x35	Box	10



NP

## Screw in Mortice Cylinders (Supplied in pairs with 3 keys)

Code	MM	Product	Packed
C.TT	22	6 pin screw in mortice cylinder	Box



NP

## 200° glass door viewer C/W shutter

DV-015  
ET-14.SCP

SCP PCP FR 30



- All models with highly polished optical glass lenses.
- By extending male screw, female screw, or both (or by shortening), the door viewer can easily be adjusted for any door thickness.
- Material : brass.
- Door thickness : 35-60mm (3-3/8" – 2-3/8").

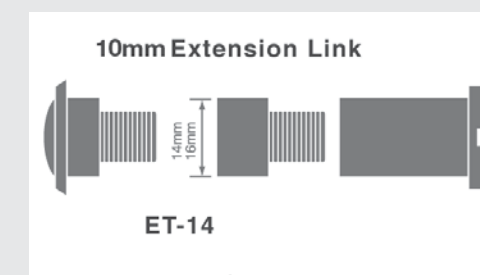
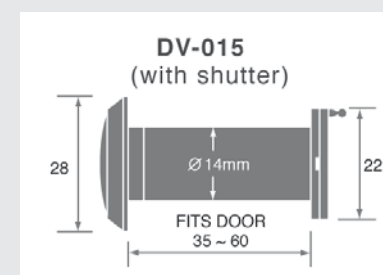

Extensions are modular in 10mm increments.

Proposed Classification in accordance with DHF Technical Specification 002 : Door viewers : November 2005

-	-	-	1	-	3	3	M
---	---	---	---	---	---	---	---

### Associated Standards

BS EN 1634-1:2000 Fire resistance tests for door and shutter assemblies – Part 1: Fire doors and shutters  
BS EN 1670:1998 Building hardware – Corrosion resistance – Requirements and test methods  
BS EN 60529:1992 Specification for degrees of protection provided by enclosures (IP code)

## Door Viewer & Screen

### DDV

110 degrees



- Photo & video shooting mode
- Doorbell state icon (Normal mode & do not disturb mode)
- Power state icon
- System date icon
- Up to 99999 picture storage (Depends on volume of memory card)
- Different languages available



Door Viewer

### DDVS Screen

SILV



- Door thickness: 40-70mm
- Door barrel diameter: 14-26mm
- Camera: 0.3 mega pixels
- LCD Screen: 3.5" TFT
- Power: 4 AA batteries
- Memory card: Micro SD card (TF), max 8GB
- Photo volume for 1GB: 15000pc (lab condition, the actual volume could differ under different circumstances)
- Inferred wavelength: 940nm
- Screen size: 135 (L) x 86 (W) x 25 (T)mm
- Weight: 310g

## Door chain DC-018

SSS PSS

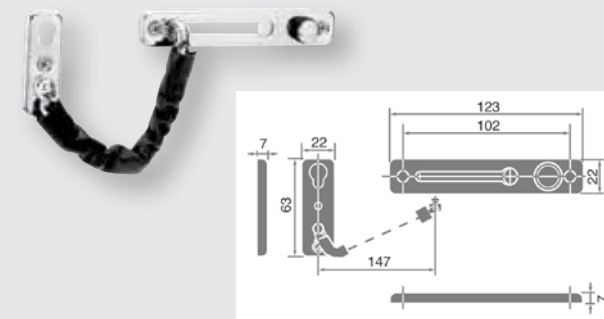

## Door guard with buffer DG-109

PCP SCP

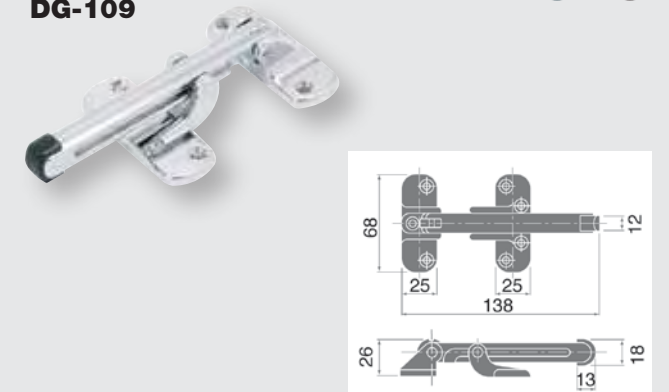

## Door guard with protector DG-110

PCP SCP

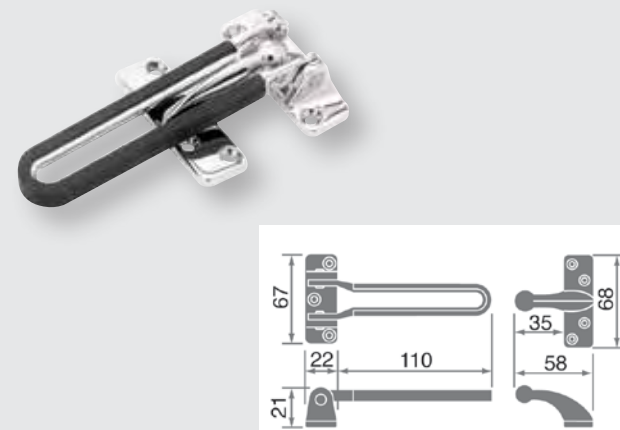

## Door guard DG-106N

PCP SNP

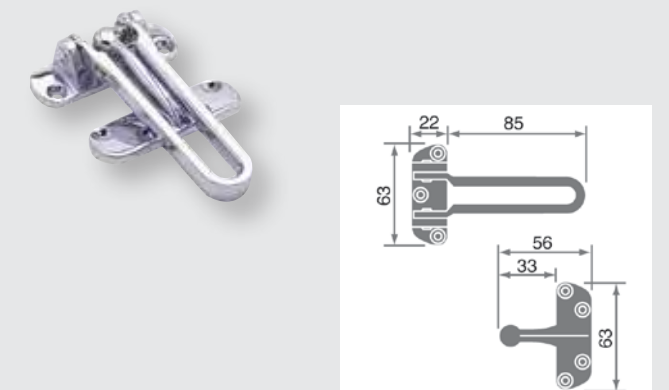

## Concealed Door Guard Chain MC41

PCP SNP FR 60

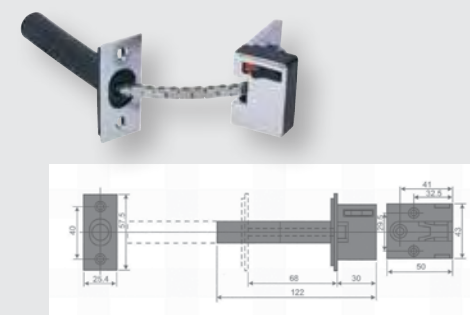

## Door Chain DC-3000

PCP SCP PB

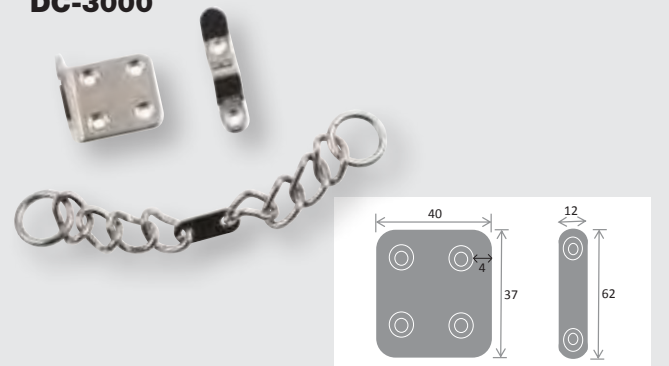



KA = Keyed Alike KD = Keyed Differ

## Secure Ring

NS.SR Standard

WHT SILV



## Side Light Secure Ring

NS.SRSL

WHT SILV



## Door Jammer

NS.DJ

120x65mm

RED



## Laminated Standard Padlocks

Code	Keyed	Packed	Keys	Dimensions (mm)							
				A	B	C	D	E	F	G	Blank
BP30	KD	VP	5	31	26.4	14.5	17.5	17.5	5	22.5	PAD 1
BP30.KA	KA	Boxed	2	31	26.4	14.5	17.5	17.5	5	22.5	PAD 1
BP40	KD	VP	5	40	33	20.5	24	22.5	6.1	30.1	PAD 2
BP40.KA	KA	Boxed	2	40	33	20.5	24	22.5	6.1	30.1	PAD 2
BP50.	KD	VP	5	50	37.5	24.5	27.5	26	8.8	36.3	PAD 2
BP50.KA	KA	Boxed	2	50	37.5	24.5	27.5	26	8.8	36.3	PAD 2
BP65	KD	VP	5	65	45	30	38	31	11	49	PAD 3

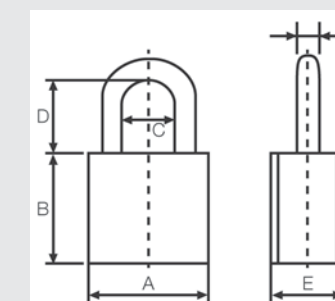

## Laminated Long Shackle Padlocks

Code	Keyed	Packed	Keys	Dimensions (mm)							
				A	B	C	D	E	F	G	Blank
BPLS.30	KD	VP	5	31	26.4	14.5	37	17.5	5	42	PAD 1
BPLS.50	KD	VP	5	50	37.5	24.5	60	26	8.8	68.8	PAD 2

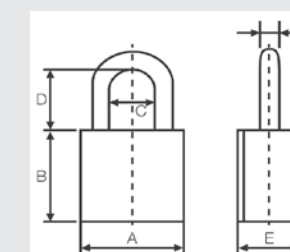

# Padlocks

KA = Keyed Alike KD = Keyed Differ

## Laminated Adjustable Shackle Padlocks

Code	Keyed	Packed	Keys	Dimensions (mm)							Blank
				A	B	C	D	E	F	G	
BP45.AS166	KA	VP	5	45	33	21	159 to 109	23.5	7	166 to 116	N/A
BP45.AS88	KA	VP	5	45	33	21	38 to 28	23.5	7	45 to 35	N/A

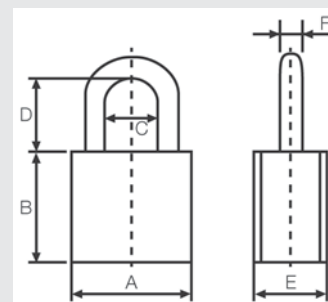

## Digital "10" Combination Padlock

NS.DP40

Code	Keyed	Packed	Keys	Dimensions (mm)						
				A	B	C	D	E	F	G
DP40	Combi	VP	N/A	40	36	23	25	10	4.5	29.5

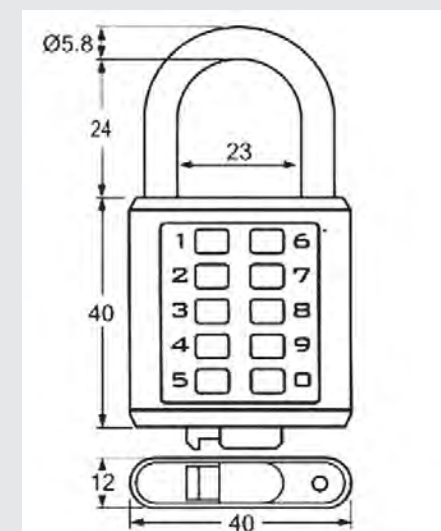

## Laminated Waterproof Standard Padlocks

Code	Keyed	Packed	Keys	Dimensions (mm)							Blank
				A	B	C	D	E	F	G	
BPWP30	KD	VP	5	39	30	13.5	14	28	6	20	PAD 4
BPWP40	KD	VP	5	49	40	19.5	19.5	31	7.5	27	PAD 5
BPWP50	KD	VP	5	59	44	22.5	23	35	10.5	33.5	PAD 6

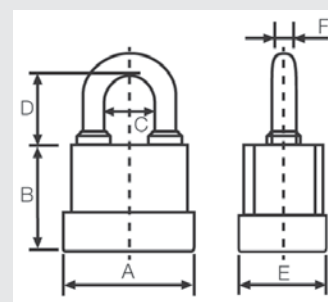

## Locking Hasp and Staple with 2 Keys

NS.HL115

NSHL75

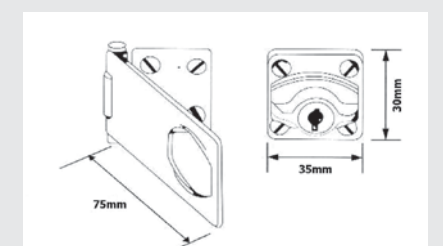
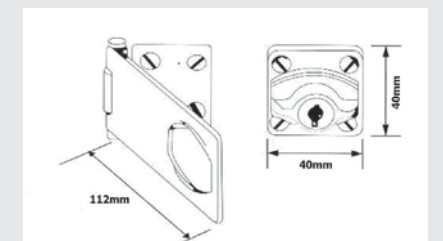

KA = Keyed Alike      KD = Keyed Differ

## Gas Meter Lock & Key

**NS.GML.LOCK****NS.GMK.KEY**

Code	Material	Positions	Key Pulls	Turns
NS.GML	3	2	-	90 degrees

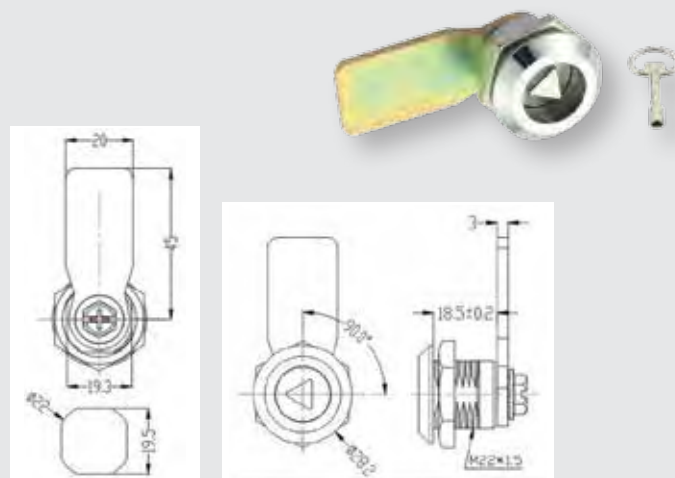

## Filing Cabinet Lock

**NS.G02006**

**NS.G02006.KD13**

## 2 Keyed Polybagged

Code	Material	Positions	Key Pulls	Turns
NS.G02006	3	2	1	135 degrees

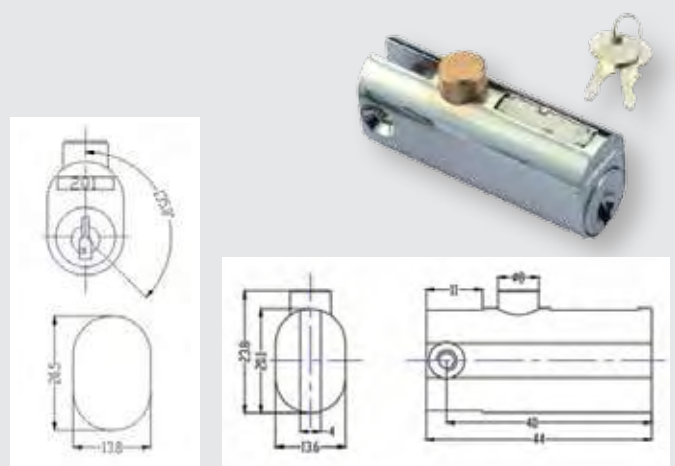

## Cam Lock

**NS.G22067.KA**

**NS.G22067.KD6**

## 2 Keyed Polybagged

Code	Material	Positions	Key Pulls	Turns	L1
NS.G22067	3	2	1	90 degrees	30mm

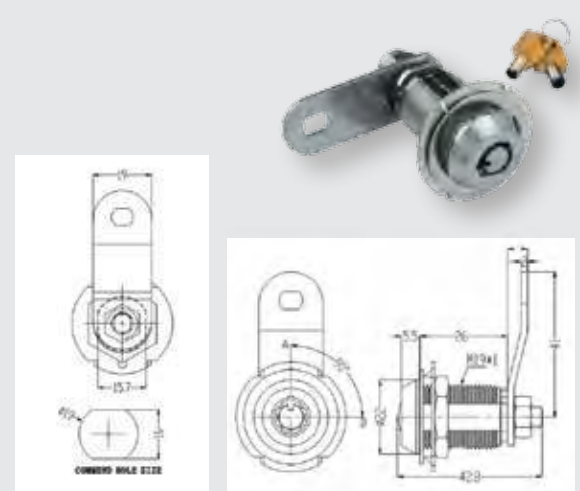

## Multi-Locks

KA = Keyed Alike      KD = Keyed Differ

## Cam Lock

**NS.G02823.KA**

**NS.G02823.KD13**

## 2 Keyed Polybagged

Code	Material	Positions	Key Pulls	Turns
NS.G02006	3	2	1	135 degrees

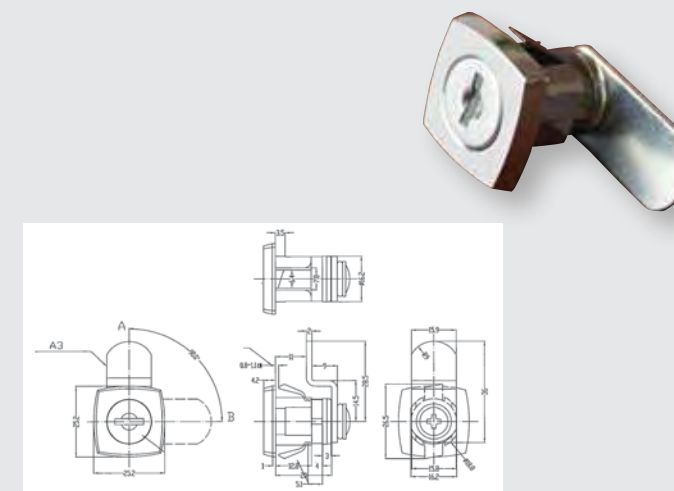

## Cam Lock

**NS.G2H800.KA**

## 2 Keyed Polybagged

Code	Material	Positions	Key Pulls	Turns
NS.G2H800	3	2	2	90 degrees

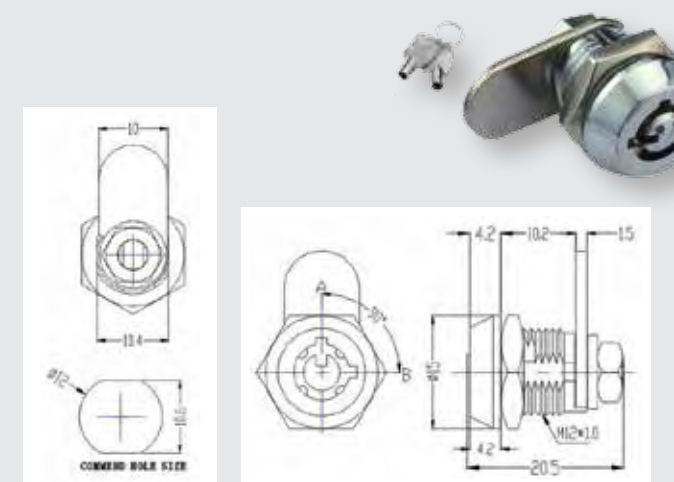

## Cam Lock

**NS.G25062.KA**

## 2 Keyed Polybagged

Code	Material	Positions	Key Pulls	Turns
NS.G25062	3	2	2	90 degrees

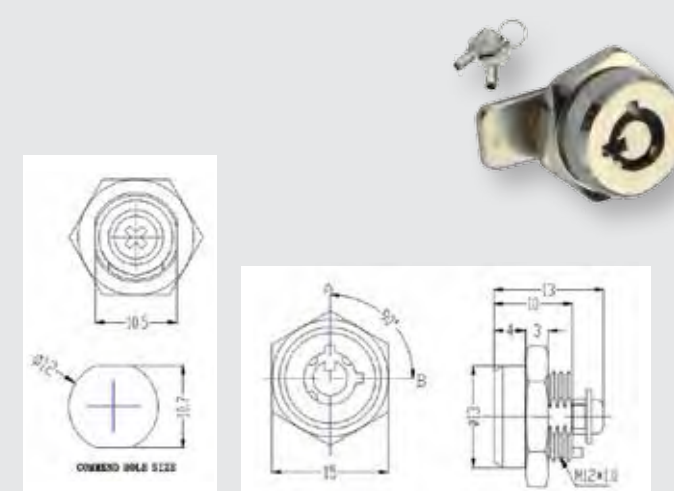



## Cam Lock

**NS.G05130.KA**

**NS.G05130.KD**

2 Keyed Polybagged

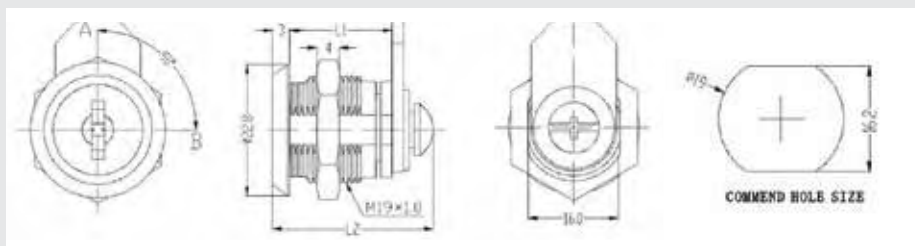

Code	Material	Positions	Key Pulls	Turns	L1	L2	Differs
NS.G05130/11	3	2	2	90 degrees	11mm	19mm	—
NS.G05130/16	3	2	2	90 degrees	18mm	27mm	160
NS.G05130/20	3	2	2	90 degrees	20mm	28mm	160
NS.G05130/22	3	2	2	90 degrees	22mm	30mm	160
NS.G05130/27	3	2	2	90 degrees	27mm	35mm	280
NS.G05130/32	3	2	2	90 degrees	32mm	40mm	280

## Glass Door Lock

**NS.GL1**

Chrome plated glass door lock suitable for glass up to 9mm thick.  
Set comprises of lock c/w 2 keys plus strike for wood frame or glass to glass.

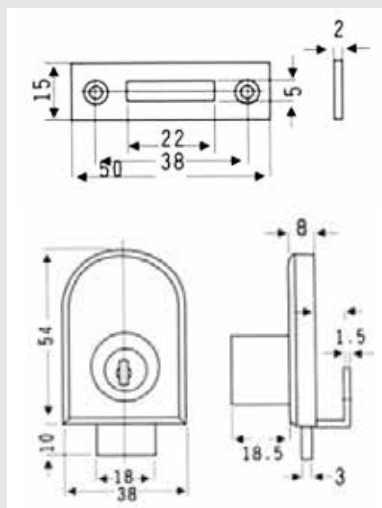

## Double Handed Lock

**NS.G47007.KA**

**NS.G47007.KD280**

2 Keyed Polybagged



Code	Material	Positions	Key Pulls	Turns
NS.G47007	3	2	2	180 degrees

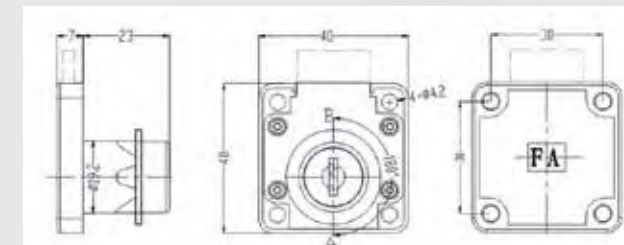

## Multi Draw Lock

**NS.G47010.KA**

**NS.G47010.KD160**

2 Keyed Polybagged



Code	Material	Positions	Key Pulls	Turns
NS.G47010	3	2	1	180 degrees

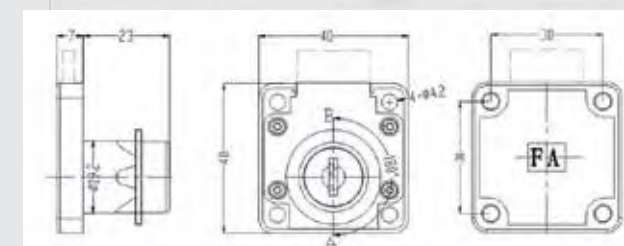

## Sliding Lock

**NS.G47004.KA**

**NS.G47004.KD160**

2 Keyed Polybagged



Code	Material	Positions	Key Pulls	Turns
NS.G47004	3	2	2	—

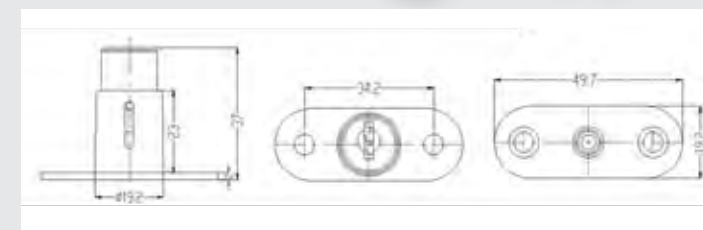

## Specialist Keys

### Universal Drop Key

**UDK**



**BZP**

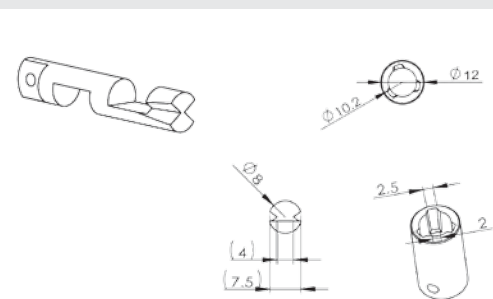

### Elevator Lift Key

**ELK**



**BZP**

### Firemans Lift Key

**FDK**

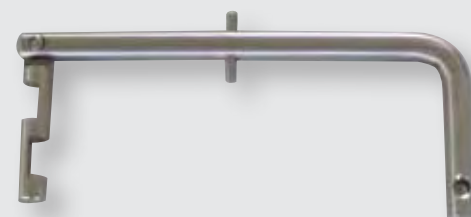

**SSS**

### General Utility Key

**NS.GUK**



### Gas Meter Key

**NS.GMK**



### T Key

**NS.F**



### Mortice Door & Window Bolt Key

**NS.316**



### Key Blank Yale/Universal Type

**LRB.KEY**



### Laminated Padlock Blank

**PAD.1/2/3**

see page 44



### Waterproof Padlock Blank

**PAD.4/5/6**

see page 45



### Key

**FB1.KEY.150mm**

**FB1.KEY**



### Key

**FB2.KEY.150mm**

**FB2.KEY**



### Key

**FB4.Key.150mm**



### LFB Key



### LFB11 Key



### LFB14 Key



## RIM Locks & Espagnolettes

### Rim Lock

**NS.RL1**



**PB EB PCP SCP GS BLK**

### Rim Latch

**NS.RL2**

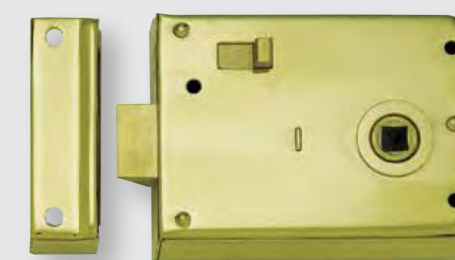

**SCP PCP PB**

### Espagnolette Bolt

**NSEB1**

C/W locking attachment to suit maximum door height 3000mm

**SCP PCP PB**



### Locking Espagnolette Bolt

**NSEB2**

C/W euro profile cylinder, fixing angle and flat mortice plates supplied to suit maximum door height 3000mm

**SCP PCP PB**

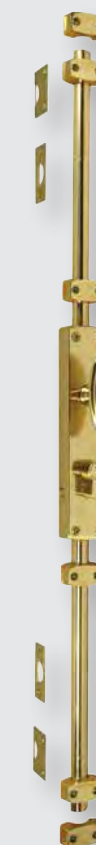

## Standard Panic Bolts

### Panic Latch

#### NS.Panic 1

760mm



### Panic Bolt

#### NS.Panic 2

760mm



### Rebated Double Panic Bolt

#### NS.Panic 3

760mm

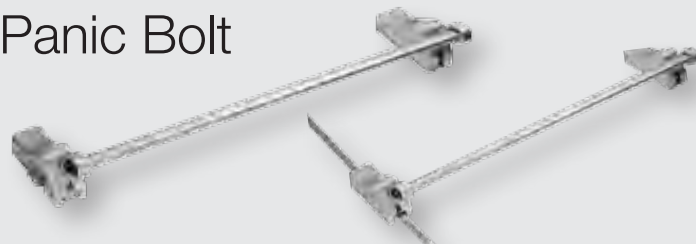

#### NS.Panic 4

Pushpad latch 125mm x 90mm



#### NS.Panic 5

External locking attachment  
C/W cylinder 125mm x 90mm



#### Benefits at a glance

- Exceptional quality and value
- Outstanding safety and security
- Meets legislative requirements
- Easy to operate
- Flexible in application and use
- Stylish yet durable
- Simple fixing
- 10 year guarantee
- Supplied as complete kit of parts
- Easi-Close latch
- Easi-reverse latch

## Touchbar Panic Bolts

### Panic Latch

#### NS.Panic 6

760mm c/w strikes

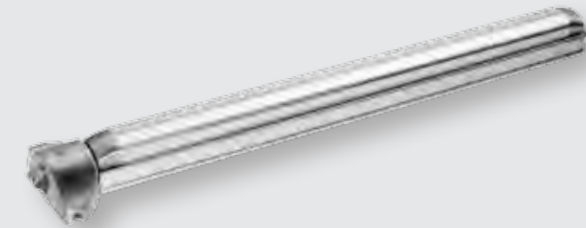

### Panic Bolt

#### NS.Panic 7

760mm c/w vertical pullman latches, rods & covers

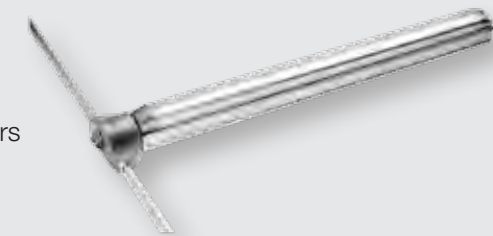

### Rebated Double Panic Bolt

#### NS.Panic 8

760mm



#### Benefits at a glance

- Type B Touchbar and Pullmans BS1125:1997
- Projection Grade 2 – Low Profile
- Successfully fire tested to BS1634:2000, Fire Rated 30/60 minutes
- Combines safety and optimum security
- 2/3 point vertical panic bolt
- Aesthetic silver/satin stainless steel finish
- Grade 1 safety, Grade 3 high frequency of use
- Maximum durability, maximum frequency
- Photo-luminescent pinstripe
- Touchbar comes complete with double door strike and single door strike included as standard
- Easi-Close latch

### Marke 1 Bolt



BZP

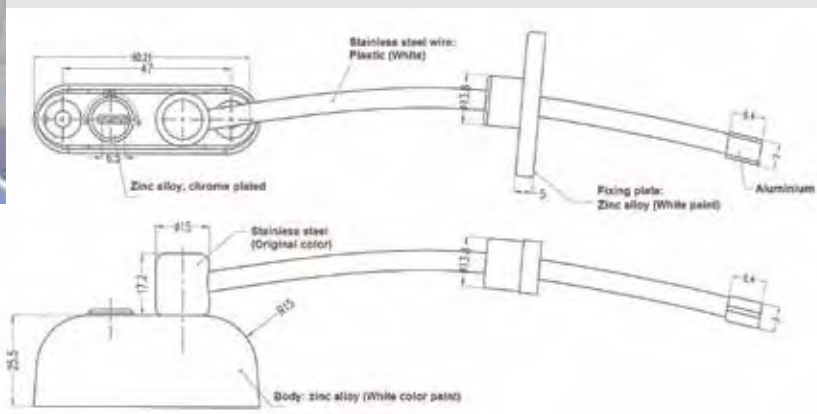

## Door & Window Restrictor

**WL1**

- The **BARRY** Restrictor limits the opening of doors and windows. Particularly designed with window safety in mind, due to the number of accidents occurring through window openings exceeding that of a child's size.
- The **BARRY** Restrictor is lockable and comes with a cable length of 200mm. All keys are within a passing group which ensures ease of use within a single dwelling. The **BARRY** Restrictor can be fitted on wood, aluminium, PVC and steel. Supplied with tamper proof screws once fitted the likelihood of abuse is minimized. The **BARRY** Restrictor is available in white only.
- The **BARRY** Restrictors are multi-faceted and are ideal for houses, apartments, commercial premises and public buildings. Supplied with a disc lock mechanism the **BARRY** Restrictor will improve the security of buildings and the safety of its occupants.

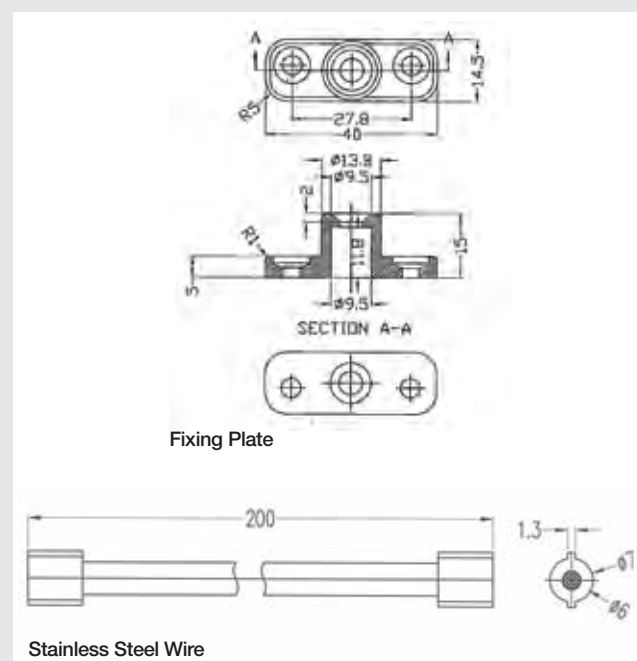

**WHT** **PCP** **PB** **SNP**

Lockable window  
stay c/w Key

## WFL1

250mm

**WHT** **PCP** **PB** **SCP**



Victorian Locking  
Night Vent c/w Key

### WFL3

16mm x 60mm

PCP PB SCP



Locking Fitch pattern  
sash fastener c/w Key

**WFL5**

64mm x 25mm

PCP PB SCP



Lockable casement  
fastener c/w Key  
Handle 124mm

**WFL2**

Projection 30mm

**WHT** **PCP** **PB** **SCF**



Lockable casement  
fastener c/w Key

WFL4

13mm x 57mm

PCP PB SCF



Lockable  
casement stay  
pin c/w Key

WFL6

40mm x 15mm

**PB** **PCP** **SCP** **BLK** **FB**



# Window Fittings

## Julietta Window Stay

**WFD1**

250mm



PB PCP SCP SNP

## Bulb end casement stay

**WFB1** 200mm

**WFB2** 250mm

**WFB3** 300mm



PB PCP SCP

## Sliding screw down stay

**WFE1** 250mm

**WFE2** 305mm



PB

## Window stay

**WFA1** 200mm

**WFA2** 250mm

**WFA3** 300mm



PB PCP SCP

## Window stay

**WFA4** 200mm

**WFA5** 250mm

**WFA6** 300mm



PB PCP SCP

## Julietta casement fastener

**WFD2**

Handle 115mm  
Projection 39mm



PB PCP  
SCP SNP

## Bulb end casement fastener

**WFB4**

Handle 100mm  
Projection 37mm



PB PCP SCP

## Wedge fastener

**WFC1**

Handle 107mm  
Projection 34mm



PB

## Night vent fastener

**WFC2**

Handle 112mm  
Projection 33mm



PB

## Casement fastener

**WFA7**

Handle 105mm  
Projection 33mm



PB PCP SCP

## Casement fastener

**WFA8**

Handle 105mm  
Projection 33mm



PB PCP SCP

## Sash fastener

**WF1**

70mm



PB PCP SCP

## Budget fastener

**WF3**

45mm

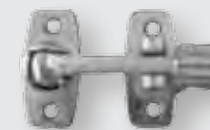

EB ZP

## Narrow Fitch fastener non locking

**WF5**

65mm



PB PCP SCP

## Budget Fitch fastener

**WF7**

70mm



EB ZP

## Fanlight catch

**WF9**

56mm x 36mm



PB PCP SCP

## Sash handle

**WF11**

**WF12**

**WF13**

100mm • 125mm • 150mm



PB PCP SCP

## Sash pulley zinc plated face & nylon roller

**WF15**

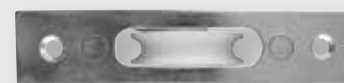

BZP

## Brighton fastener

**WF2**

55mm

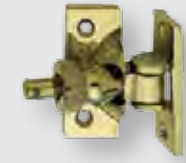

PB PCP SCP SNP

## Heavy Brighton fastener

**WF4**

58mm

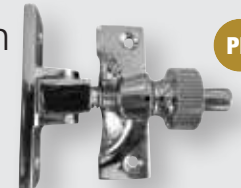

PB PCP SCP

## Narrow Fitch fastener locking

**WF6**

65mm



PB PCP SCP

## Sash fastener

**WF8**

70mm



PB PCP SCP

## Fanlight catch

**WF10**

63mm



PB PCP SCP

## Sash lift

**WF14**

50mm



PB PCP SCP SNP

## Sash pulley brass roller

**WF16**



PB PCP SCP

# Window Fittings

## Sash fastener

**WF1**

70mm



PB PCP SCP

## Budget fastener

**WF3**

45mm

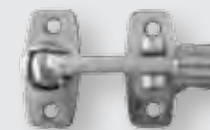

EB ZP

## Narrow Fitch fastener non locking

**WF5**

65mm



PB PCP SCP

## Budget Fitch fastener

**WF7**

70mm



EB ZP

## Fanlight catch

**WF9**

56mm x 36mm



PB PCP SCP

## Sash handle

**WF11**

**WF12**

**WF13**

100mm • 125mm • 150mm



PB PCP SCP

## Sash pulley zinc plated face & nylon roller

**WF15**



BZP

## Brighton fastener

**WF2**

55mm

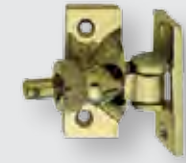

PB PCP SCP SNP

## Heavy Brighton fastener

**WF4**

58mm

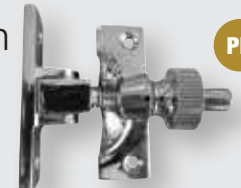

PB PCP SCP

## Narrow Fitch fastener locking

**WF6**

65mm



PB PCP SCP

## Sash fastener

**WF8**

70mm



PB PCP SCP

## Fanlight catch

**WF10**

63mm



PB PCP SCP

## Sash lift

**WF14**

50mm



PB PCP SCP SNP

## Sash pulley brass roller

**WF16**



PB PCP SCP

# Catches

# Bary bolts



KA = Keyed Alike KD = Keyed Differ

## Door Catch

**NS.CA1**

57mm

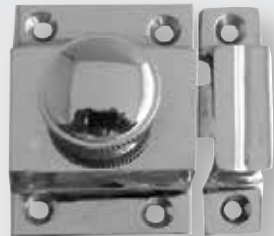

PB PCP SCP

## Showcase Catch

**NS.CA2**

42mm



PB

## Throw Over Catch

**NS.CA3**

55mm



PB PCP

## Throw Over Catch

**NS.CA4**

52mm

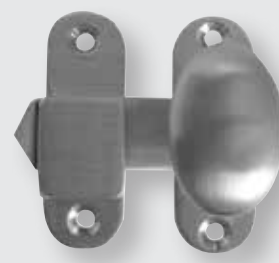

PB PCP SCP

## Double Ball Catch

**NS.CA5**

42mm  
50mm  
60mm  
70mm

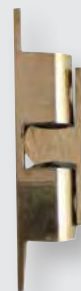

PB

## Throw Over Catch

**NS.CA6**

42mm  
62mm



WHT

## Double Roller Catch

**NS.CA7**

31mm



ZP

## Touch Catch

**NS.CA8**

75mm



ZP

## Multi purpose bolt

**PDB**

KA or KD

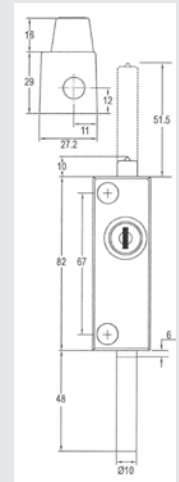

WHT

## Patio door bolt

**WB**

KA or KD

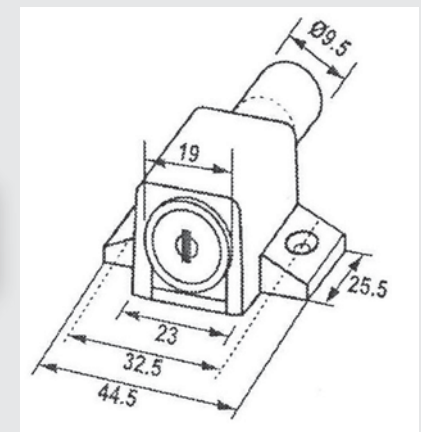
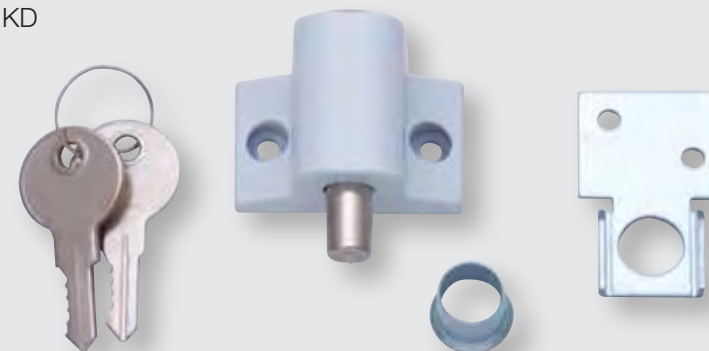

WHT

## Window sash stop

**WSS**

PR C/W key

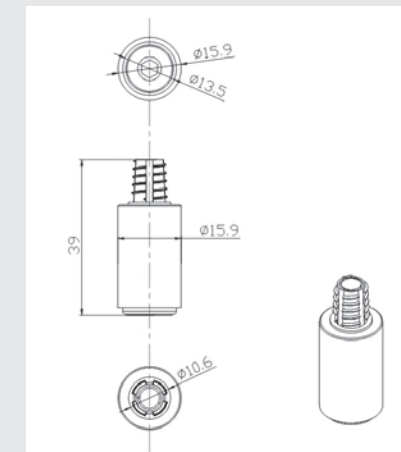
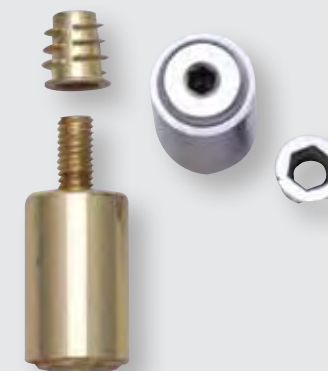

PB PCP



## Window & Door Security

## Parking Posts

KA = Keyed Alike KD = Keyed Differ

### Mortice Door Bolt

**NS.315**

60mm Square



### Mortice Door Bolt Radius

**NS.315R**

60mm



### Mortice Door Bolt Thumbturn

**NS.277**

30mm



### Mortice Door & Window Bolt Key

**NS.316**



### Mortice Door Bolt

**NS.315/88**

88mm Square



### Mortice Window Bolt

**NS.796**

35mm



### Dropdown Parking Post

**NS.PP1 KA**

**NS.PP1 KD**

Integral Lock  
c/w two keys  
(Three fixing bolts required, not supplied)



### Dropdown Parking Post

Padlock (not supplied)

**NS.PP2**

5KG  
Base 100x175mm  
Post 65mm O/D 700mm long  
(Two fixing bolts required, not supplied)



### Heavy Duty Toplock Parking Post

**NS.PP3**

5KG  
(Two fixing bolts required, not supplied)

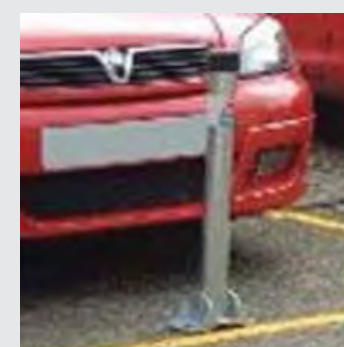

### Large Parking Barrier Top Padlock

Padlock (not supplied)

**NS.PP4**

Base Plate 305x260mm  
Post 690mm high  
(Four fixing bolts required, not supplied)

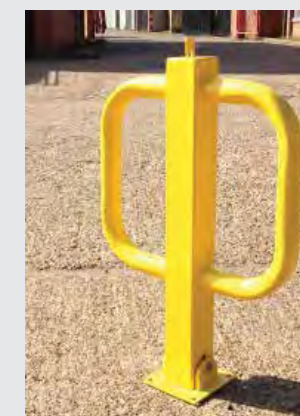

### Concrete Expanda Bolt

**NS.PPB1**

(sold as each)

### Tarmac Expanda Bolt

**NS.PPB2**

(sold as each)

## Flush Bolts

### Mortice Lever Action 19mm

Bolt ø 11mm  
Shoot 13mm

**FB150** – SSS + PSS  
**FB200** – SSS + PSS  
**FB300** – SSS only  
**FB600** – SSS only



### Radius Mortice Lever Action 19mm

Bolt ø 11mm  
Shoot 13mm

**FBR.150**  
**FBR.200**  
**FBR.300**  
**FBR.600**



### Surface Lever Action Bolts 19mm

**FB-019.200**  
**FB-019.300**



### Metal Door Lever Action Flush Bolt

**FB25.300**

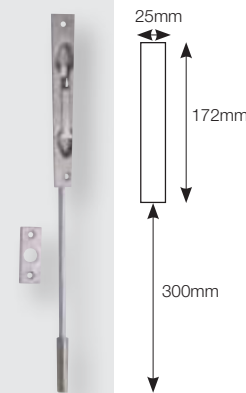

### Flush Door Strike (Extra)

**FB-019.TOPSTRIKE**



### Solid Stainless Steel Flush Door Strike

(Supplied as standard)

**FB.STRIKE**



### Easiclean Socket

**EC1**

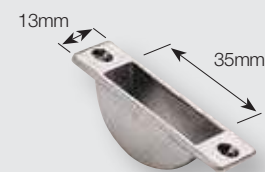

### Dust Excluding Socket

**DE1**



## Locking Bars, Hasp & Staples, Decorative Locks

### Locking Bar

**NS.K1**

152 x 57mm



### Locking Bar

**NS.K2**

203 x 38mm  
254 x 41mm  
305 x 44mm  
356 x 48mm  
406 x 51mm  
457 x 64mm  
508 x 64mm



### Locking Bar

**NS.K3**

610 x 64mm  
762 x 64mm  
915 x 64mm



### Locking Bar

**NS.K4**

152 x 127 x 57mm

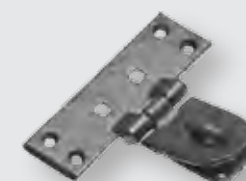

### Locking Bar

**NS.K5**

127 x 83 x 29mm



### Locking Bar

**NS.K6**

152 x 38mm  
203 x 38mm  
254 x 41mm  
305 x 44mm  
356 x 48mm  
406 x 51mm  
457 x 60mm  
508 x 60mm



### Rim Lockset

**NS.K7L** - Latch

**NS.K7D** - Deadlock

125 x 103 x 19mm

Lock, latch or deadlock. Supplied with 1550 knob, oval escutcheon and Wilkes spindle. Lock body.

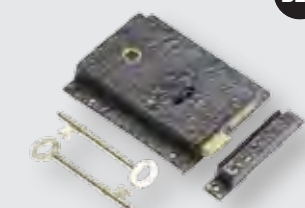

### Mortice Lock

**NS.K8**

3 or 5 Lever.

Front plate 178 x 32mm

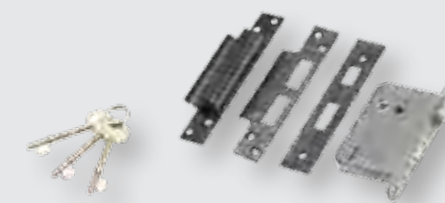

### Rim Lock

**NS.K9**

**NS.K9WK**

Available with or without knob.  
Lock body 158 x 115mm.

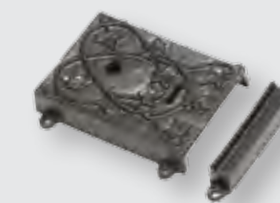

### Locking Espagnolette Bolt

**NS.K10**

2.4m – 8ft

(also available in 3.05m – 10ft as a special product)

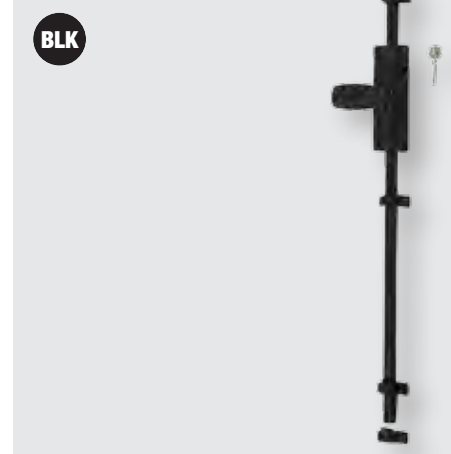

# Stick or Screw on Escutcheons

# Components (spindles & fixings)

Flat Screw Profile  
Escutcheon

**FSE2**

47 x 63.5 x 1mm



SSS

Flat Screw Keyway  
Escutcheon

**FSE3**

47 x 63.5 x 1mm



SSS

Flat Screw Blank  
Escutcheon

**FSE6**

47 x 63.5 x 1mm



SSS

Flat Adhesive Profile  
Escutcheon

**FAE2**

47 x 63.5 x 1mm



SSS

Flat Adhesive Keyway  
Escutcheon

**FAE3**

47 x 63.5 x 1mm



SSS

Flat Adhesive Blank  
Escutcheon

**FAE6**

47 x 63.5 x 1mm



SSS

Half Spindle to  
Operate Front Fix

**NS.HS**

60mm



Half Spindle  
Fixed Dead

**NS.FD**

35mm



Half Spindle to  
Operate Rear Fix

**NS.HS.A**

60mm



Split Spindle

**NS.SS**

100mm

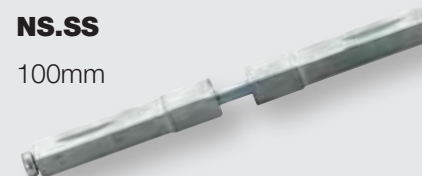

Break Through Spindle

**NS.BTS**

100mm

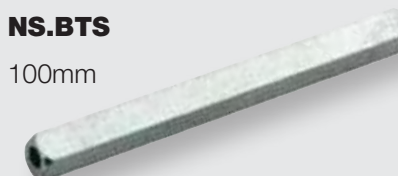

5mm Standard Spindle

**NS.SP5**

5mm 65mm

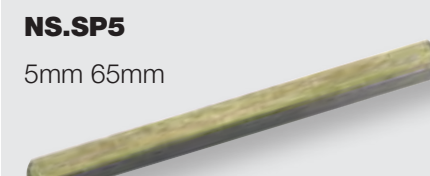

Pull Handle Bolt  
Through Fixings

**FIX 1** M8 x 60mm

**FIX 12** M6 x 90mm



5-8mm Spindle  
Adapter Metal

**SLEEVE M**



Lever Handle Bolt  
Through Fixings

**NS.BTF** 60mm

**NS.BTF.80** 80mm

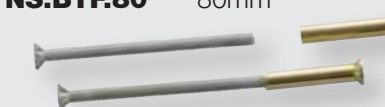

Back Plate

**RCI**

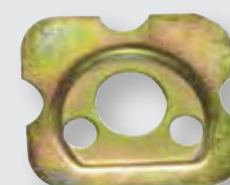

UK Locks double action  
strike plate

**C-8-C**

To suit lining  
90 - 110mm



Bolts for Rim Cylinders

**LRB.BOLTS**

40mm



Din Locks double  
action strike plate

**C-6-C**

To suit lining 90 - 110mm



**FB4.STRIKE**

SSS

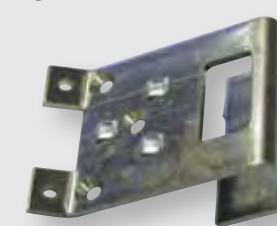

Mortice Strike

**FB.STRIKE**

SSS





## Mail Box

## Ash trays and cigarette bins

### NS.MB1

216 x 300 x 80mm

BLK WHT GRE



### NS.MB2

A – Spark  
B – Blossom  
250 x 400 x 120mm

WHT

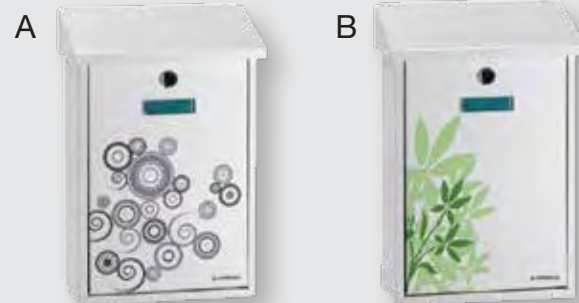

### NS.MB3

360 x 275 x 80mm

BLK WHT GRE



### NS.MB4

360 x 370 x 100mm

BLK WHT GRE



### NS.MB5

260 x 385 x 80mm

BLK WHT GRE



### NS.MB6

250 x 320 x 80mm

BLK WHT SILV



### Flip over ashtray

SSS

#### 3077

Surface mounting. Made of SUS304 stainless steel with bright finish. Flip over without removal from frame to permit ashes to be disposed easily.

Size: 42 x 115 x 100mm



### Ashtray urn

SSS

#### 3081

Surface mounting. Whole unit is made of SUS304 Stainless steel with hairline finish. Flip top ashtray is operated by pushing down button on right side, lift hinged body to remove receptacle.

Size: 280mm wide, 150mm high, 140mm deep.

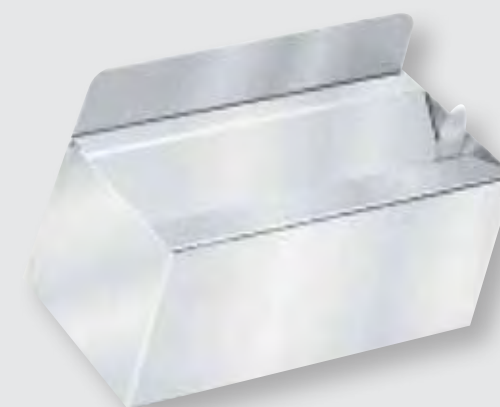

### Cigarette bin

SSS

#### CB.001

265 x 110 x 280mm



### Cigarette bin

SSS

#### CB.006

240 x 90 x 380mm



## Key Cabinets

100 Key

**NS-S100**

- Key lock
- Standard security

550 x 380 x 80mm  
Net Weight: 7.5kgs



150 Key

**NS-S150**

- Key lock
- Standard security

550 x 380 x 140mm  
Net Weight: 11.5kgs



200 Key

**NS-S200**

- Key Lock
- Standard security

550 x 380 x 140mm  
Net Weight: 12.5kgs



300 Key

**NS-S300**

- Key lock
- Standard security

550 x 380 x 205mm  
Net Weight: 17kgs



400 Key

**NS-S400B**

- Key Lock
- Standard security

550 x 730 x 140mm  
Net Weight: 22kgs



600 Key

**NS-S600B**

- Key lock
- Standard security

550 x 730 x 205mm  
Net Weight: 29kgs

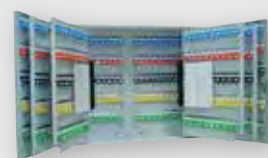

1170 Key

**NS-S1170**

- Key Lock
- Standard security

1300 x 730 x 250mm  
Net Weight: 60kgs



Key Tags

**NS-Tag**

Plastic tag



## Deposit Key Cabinets

Epoxy Powder Key Cabinet

**NS-S1011**

100 x 100 x 40mm  
Net Weight: 0.55kgs



Epoxy Powder Key Cabinet

**NS-S1021**

110 x 110 x 50mm  
Net Weight: 0.55kgs



Epoxy Powder Key Cabinet

**NS-S1022**

110 x 110 x 50mm  
Net Weight: 0.6kgs



20 Key

**NS-S2020**

- Digital combination lock
- High security

320 x 295 x 120mm  
Net Weight: 15kgs



20 Key

**NS-S0080**

- Key lock
- Standard security

200 x 160 x 80mm  
Net Weight: 1.1kgs



24 Key

**NS-S0077G**

- Combination lock
- Standard security

250 x 180 x 80mm  
Net Weight: 1.4kgs



36 Key

**NS-S0057G**

- Combination lock
- Standard security

300 x 240 x 80mm  
Net Weight: 2.9kgs



42 Key

**NS-S42**

- Key lock
- Standard security

350 x 270 x 80mm  
Net Weight: 3.2kgs



45 Key

**NS-S0050**

- Key lock
- Standard security

300 x 240 x 80mm  
Net Weight: 2.1kgs



45 Key

**NS-S48**

- Key lock
- Standard security

370 x 280 x 80mm  
Net Weight: 2.9kgs



50 Key

**NS-S2050**

- Digital combination lock
- High security

400 x 340 x 120mm  
Net Weight: 20.5kgs



60 Key

**NS-S047G**

- Combination lock
- Standard security

370 x 280 x 80mm  
Net Weight: 2.4kgs



64 Key

**NS-S64**

- Key lock
- Standard security

450 x 300 x 80mm  
Net Weight: 4.5kgs



93 Key

**NS-S0060**

- Key lock
- Standard security

300 x 240 x 80mm  
Net Weight: 2.9kgs



100 Key

**S-S2100**

- Digital combination lock
- High security

400 x 550 x 120mm  
Net Weight: 27kgs





# Safes

# Door Stops

## Petty Cash Boxes

- NS.S011** 90x200x160mm
- NS.S012** 90x250x180mm
- NS.S013** 90x300x240mm

c/w two keys

RED



## Compact

- NS.S021** 170x230x170mm
- NS.S022** 250x350x250mm
- NS.S023** 500x350x310mm

c/w two keys

BLK



## Economy Electronic Lock

- NS.S031** 200x310x200mm
- NS.S032** 229x405x335mm
- NS.S033** 250x350x250mm
- NS.S034** 300x380x300mm
- NS.S035** 500x350x310mm

GR



## Hotel & Laptop Electronic lock with an over-ride key system

- NS.S041** 230x430x360mm
- NS.S042** 200x520x406mm

BLK



## Cash Deposits High Security Electronic Lock

- NS.S051** 480x340x381mm
- NS.S052** 698x340x381mm
- NS.S053** 760x508x508mm

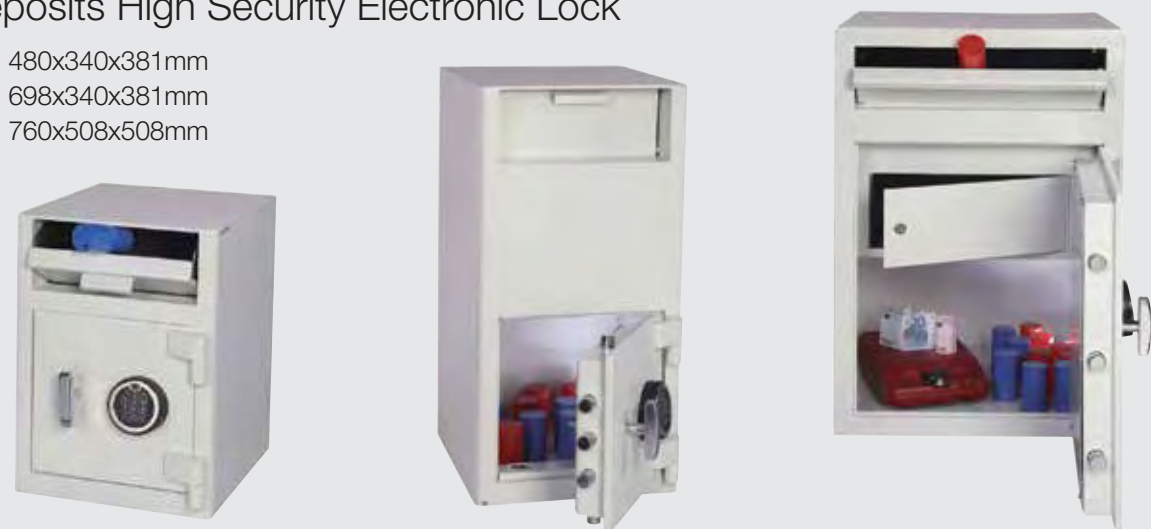

## Fully concealed door stop

SSS

**DS01**



## Fully concealed door stop

SSS

**DS02**



## Floor door stop

SSS

**DS003**



## Raised floor door stop

SSS

**DS003L**



## Umbrella door stop

SSS

**DS04**



## Door stop

**DS06**

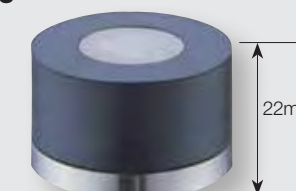

## Wall adjustable door stop

SCP

**DS-050**

Adjustable 68-98mm



## Wall door stop

SSS

**DS-051**

28mm diameter,  
8mm projection



## Wall door stop

SSS

**IDS1**

85mm projection



## Buffered hook

SSS

**5010B**



## Buffered double hook

SSS

**5010DB**



## Buffered hat and coat hook

SSS

PSS

**IHCB**



## Top jamb door stop

**DH038 LH/RH**

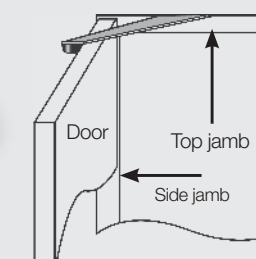

RH

SSS



Budget surface overhead door closers C€

Door closers

Surface overhead door closer (No Cover)



EN100

Functional Criteria

Door Widths from up to 950mm.  
Door Weights up to 60kg.  
Adjustments include;  
**1.** Latching Speed. Final 10 Degrees.  
**2.** Closing Speed. 10 - 105 Degrees.  
**3.** BS Size 3.

Available arms

- 1.** Standard.
- 2.** Parallel Arm bracket included (SIL).

Power Shoe arm bracket as standard

Note

When using parallel arm increase the closer power by one more size.

Do not use hold open closers on fire doors.



Classification confirmed by Intertek

GZ 09120873-1

BS EN 1154 Classification

3	8	3	1	1	3
---	---	---	---	---	---

Fire Tested by Warrington apt

BS 1634-1 2000 60 minutes

Dimensional Requirements

No cover	
Length	180mm
Height	40mm
Projection	63mm

Guarantee

10 years

A free replacement ex-works of any closer proved defective by reason either of faulty manufacture or defect in material.

Transom door closer

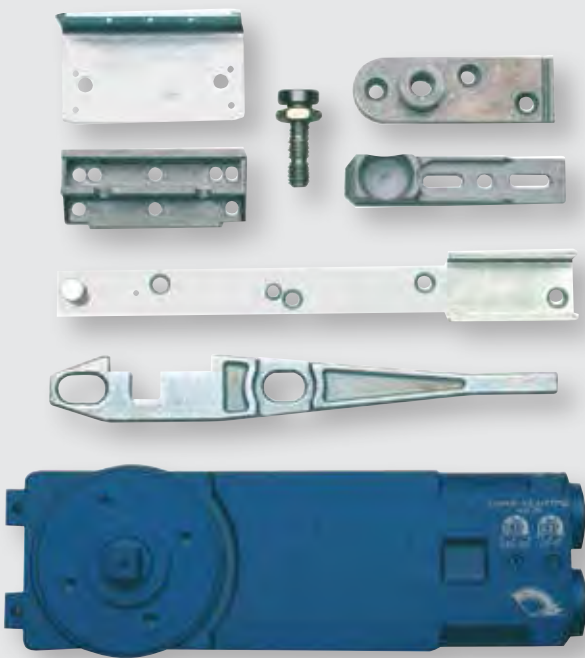

Transom Door Closer with or without hold open. Side loaded.

- Door Widths up to 1250mm.
- Door Weights up to 150kg.
- Suitable for use in temperatures from -15 to 40 Degrees Celsius.

Adjustments include;

- 1.** Latching Speed. Final 10 Degrees.
- 2.** Closing Speed. 10 - 130 Degrees.
- 3.** Spring Strength. Sizes 3 & 4.
- 4.** Adjustable Back Check. Not Available.
- 5.** Delayed Action. Not Available.

**C-103 Size 3** Non Hold Open.

**CS-103 Size 3** Hold Open.

**C-104 Size 4** Non Hold Open.

**CS-104 Size 4** Hold Open.

Not suitable for fire doors.

Can be used on wood doors. SSS cover plate required 130 x 325 x 1.5mm available. TP.TRANSOM

Plate for wooden doors

SSS

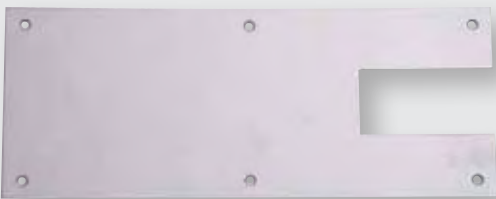

Available Arms;

- 1.** Track Arm Standard.
- 2.** Track Arm Hold Open.

Finish:

Silver Body/Polished Chrome Arm.  
Special finishes to order.

Product	Performance	Classification	Fire	QA
C-103	BSEN1154	4 8 ¾ 0 1 3	-	9001
CS-103	BSEN1154	4 8 ¾ 0 1 3	-	9001
C-104	BSEN1154	4 8 ¾ 0 1 3	-	9001
CS-104	BSEN1154	4 8 ¾ 0 1 3	-	9001

## Automatic Hand Dryer

### HK-1800PA

(Plastic ABS cover)  
Power by 220VAC  
Watts: 1800W  
Overall size (W/H/D):  
268 x 220 x 170mm



WHT CE

#### Standard:

EN60335-1: 2002 Household and similar electrical appliances – safety.  
Part 1: General requirements  
EN 60335-2-23: 2003  
Part 2-23 Particular requirements for appliances for skin care or hair care

## Push Button Hand Dryer

### HK-2400PS

(Enamelled steel cover)  
Power by 220VAC  
Watts: 2400W  
Overall size (W/H/D):  
248 x 248 x 202mm



GR CE

#### Standard:

EN60335-1: 2002 Household and similar electrical appliances – safety.  
Part 1: General requirements  
EN 60335-2-23: 2003  
Part 2-23 Particular requirements for appliances for skin care or hair care

### Abus

**104A  
AB27**

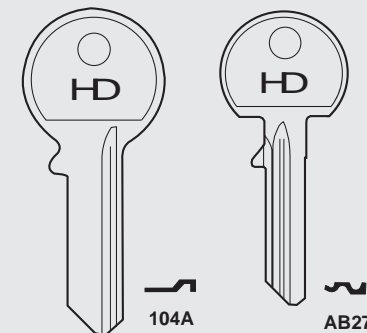

### Aldridge/Asec

**ASEC1**

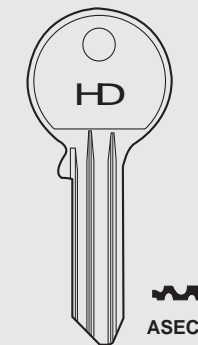

### Cisa

**7D  
N9CS  
NR9CS**

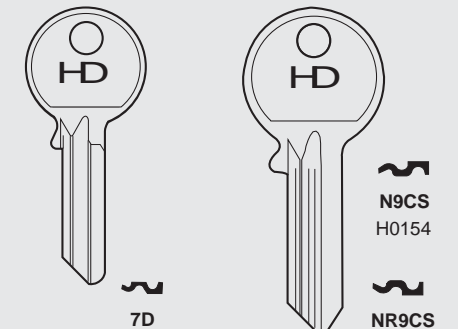

### Cisa

**NS9CS  
XU9CS**

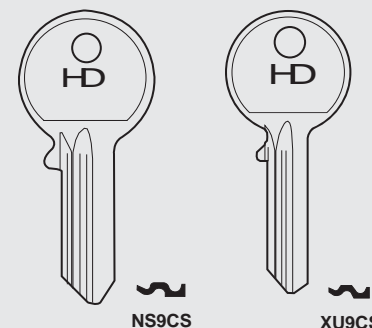

### Corbin

**CB7**

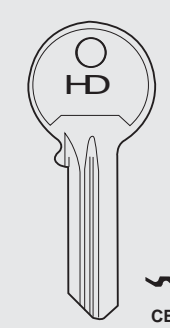

### Era

**CB7**

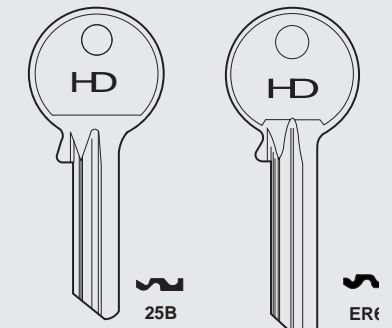

### Ewa

**EV6**



### GeGe

**62GE  
L62GE**

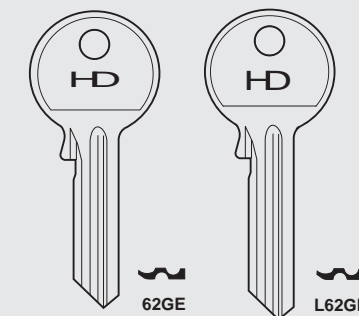

### L&F

**85P  
LF85**

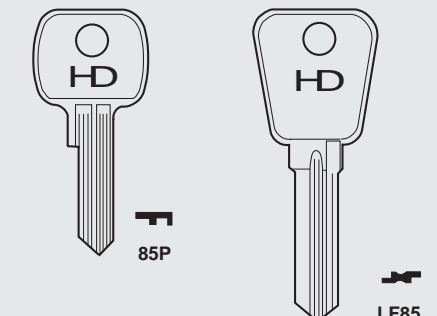

## Cylinder Key Blanks

## Mortice Key Blanks

L&F  
87R

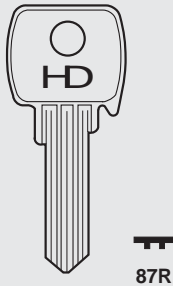

Legge  
36M



Sofi  
S04R

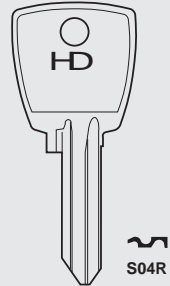

Union  
35B

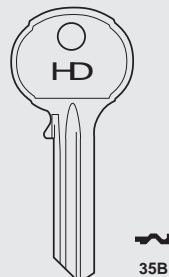

Universal  
UL1  
UL1R  
UL2

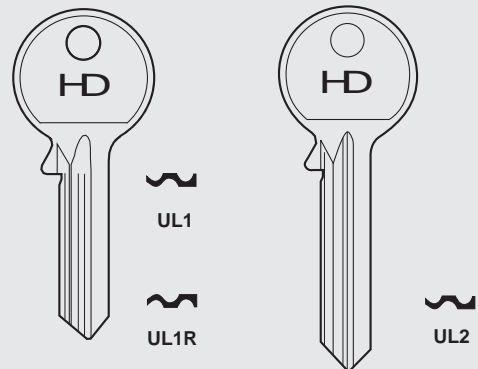

WMS  
WMS5  
WMS8

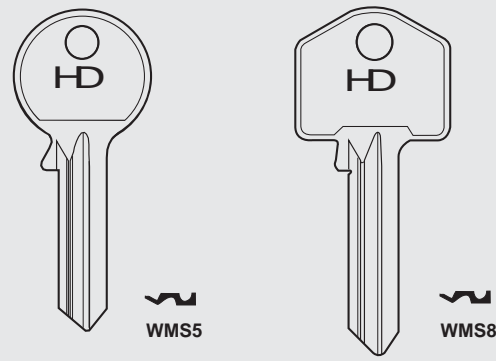

Yale  
1A  
16HL  
56B  
YAX5  
YAX1NP

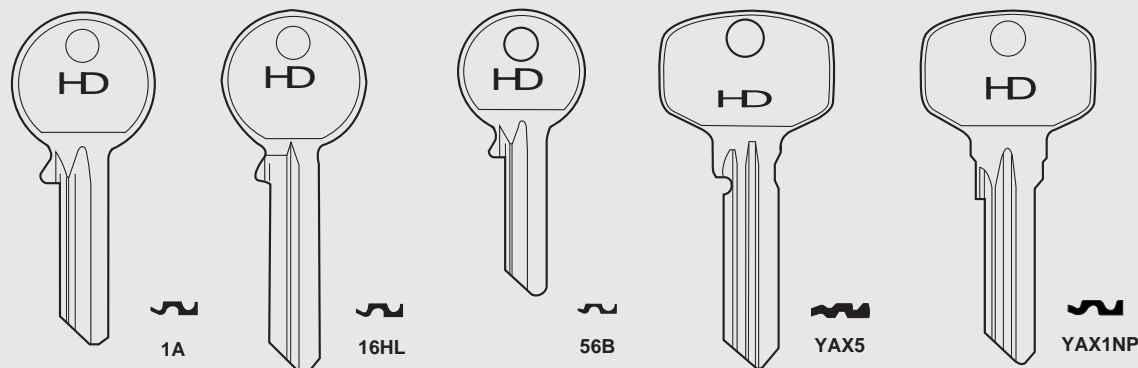

Aldridge/Asec  
B182

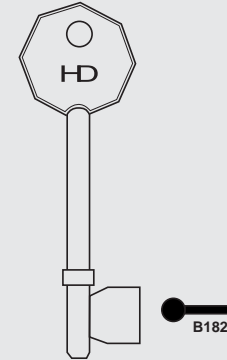

Material	Steel
Gauge	5
Finish	N/P

Chubb  
B373B  
B360B

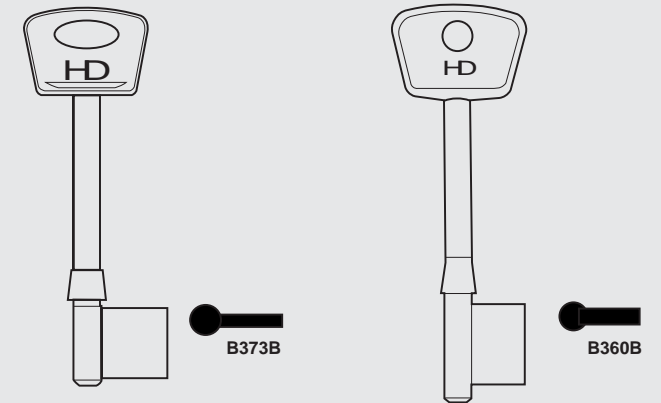

Material	Brass
Gauge	4.5
Finish	Polished

Material	Brass
Gauge	5
Finish	Polished

Disabled  
ETK504  
K504

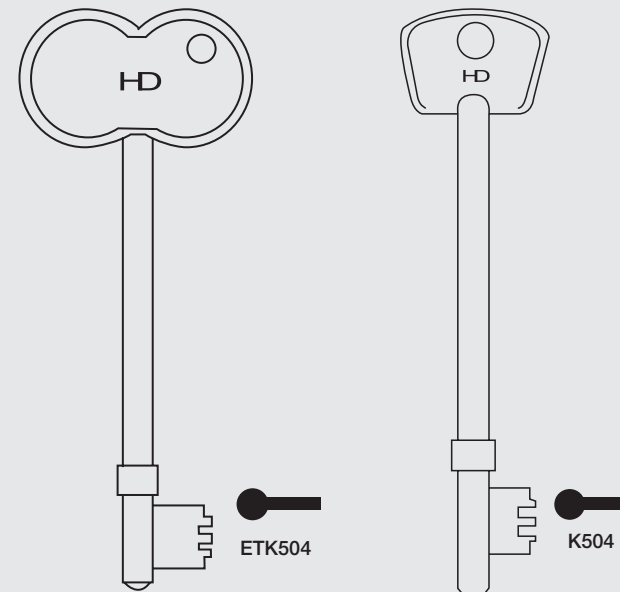

Material	Steel
Gauge	5
Finish	N/P

Material	Steel
Gauge	5
Finish	N/P

Era  
B206B

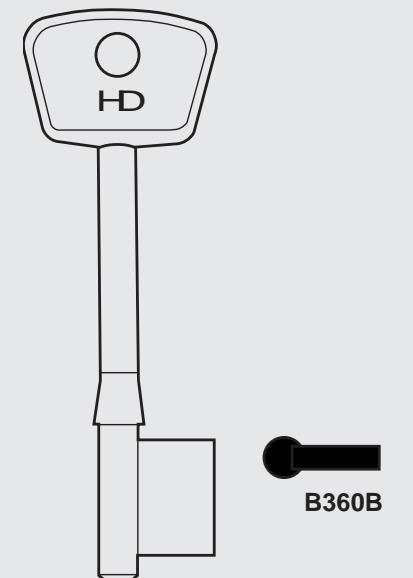

Material	Brass
Gauge	5
Finish	Polished



## Mortice Key Blanks

Era

**B201**  
**B230B**  
**B334**

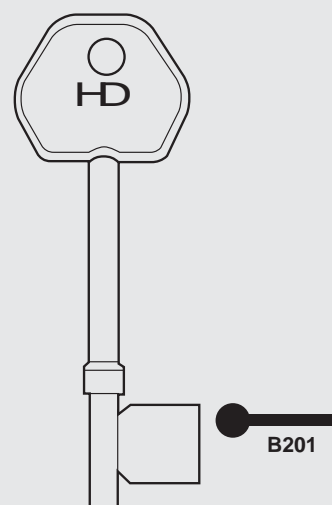

Material	Steel
Gauge	7
Finish	N/P

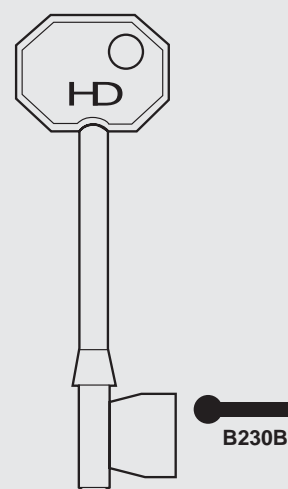

Material	Brass
Gauge	7
Finish	Polished

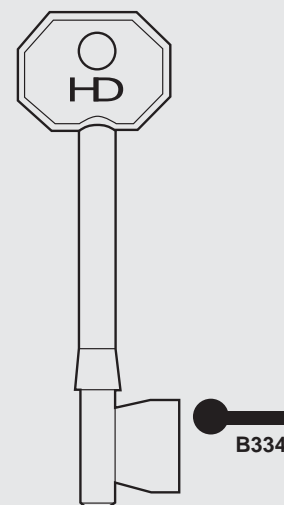

Material	Brass
Gauge	5
Finish	Polished

Guardian

**B700**

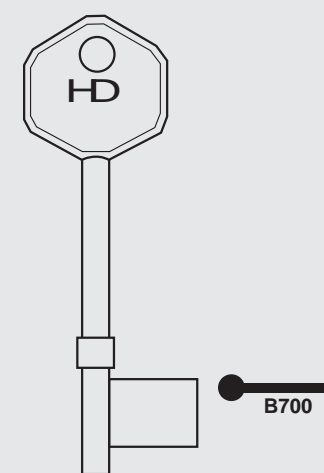

Material	Steel
Gauge	6
Finish	N/P

Legge

**B463**

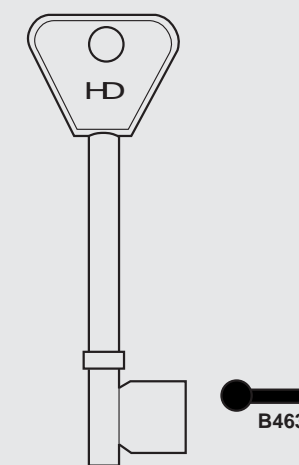

Material	Steel
Gauge	5.5
Finish	N/P

Securefast

**B571**

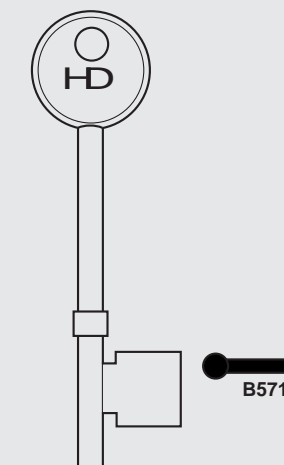

Material	Steel
Gauge	7
Finish	N/P

Era

**B609/1**

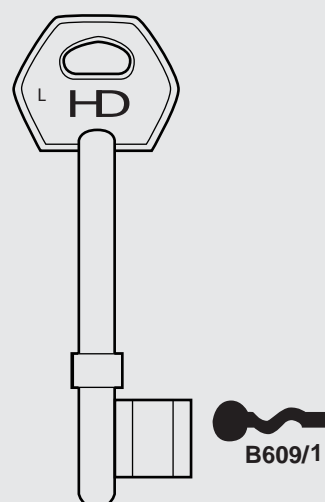

Material	Steel
Gauge	4.5
Finish	N/P

Euro

**B602/2 - Left**  
**B602/1 - Right**

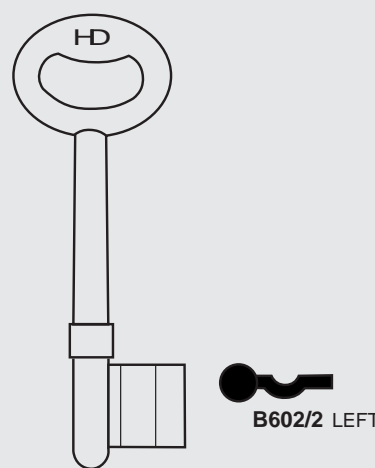

Material	Alloy
Gauge	5
Finish	Z/P

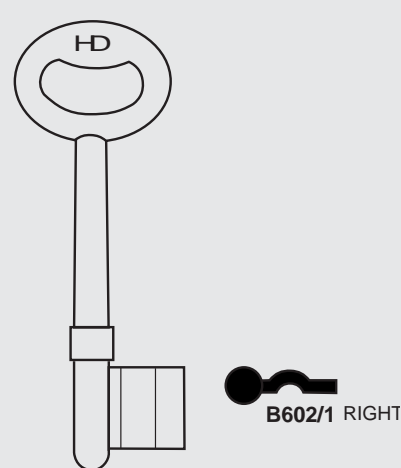

Material	Alloy
Gauge	5
Finish	Z/P

Securefast

**B572**

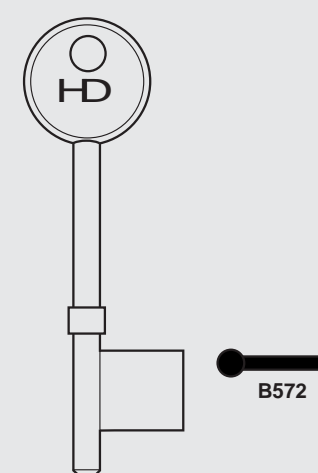

Material	Steel
Gauge	7
Finish	N/P

Spaceguard

**B593**

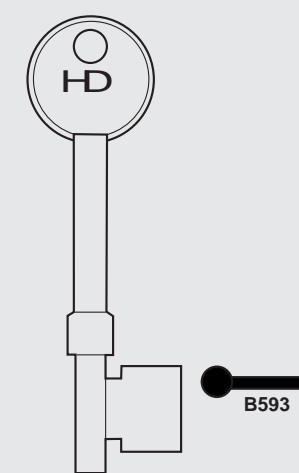

Material	Steel
Gauge	6.5
Finish	N/P

Union

**B440**

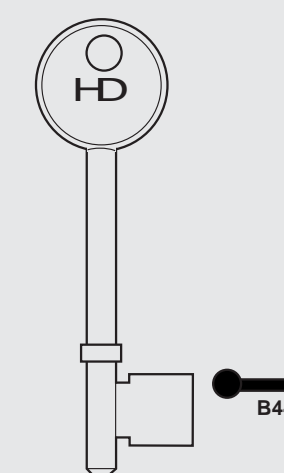

Material	Alloy
Gauge	5
Finish	Z/P

## Mortice Key Blanks

Guardian

**B700**

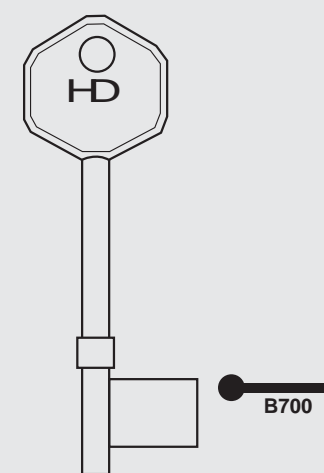

Material	Steel
Gauge	6
Finish	N/P

Legge

**B463**

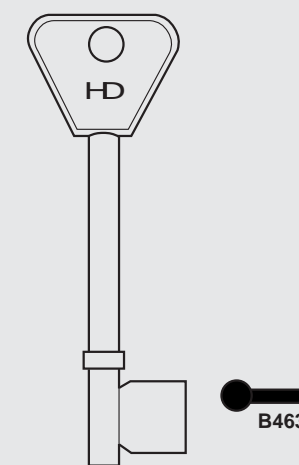

Material	Steel
Gauge	5.5
Finish	N/P

Securefast

**B571**

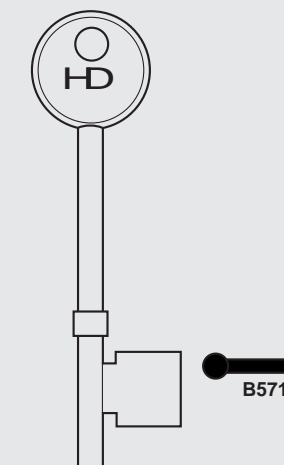

Material	Steel
Gauge	7
Finish	N/P

Era

**B609/1**

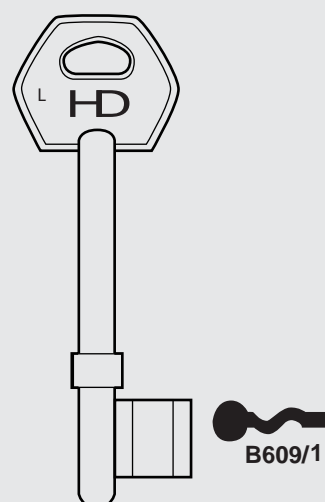

Material	Steel
Gauge	4.5
Finish	N/P

Euro

**B602/2 - Left**  
**B602/1 - Right**

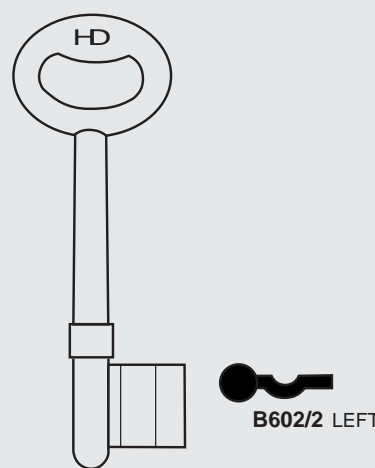

Material	Alloy
Gauge	5
Finish	Z/P

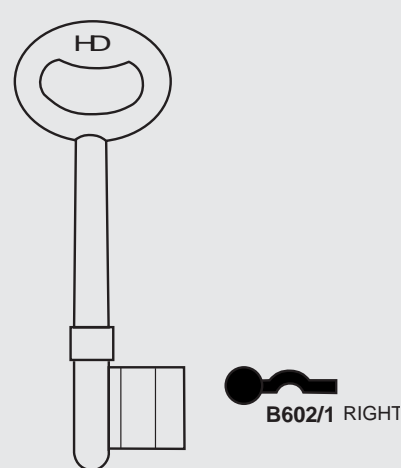

Material	Alloy
Gauge	5
Finish	Z/P

Securefast

**B572**

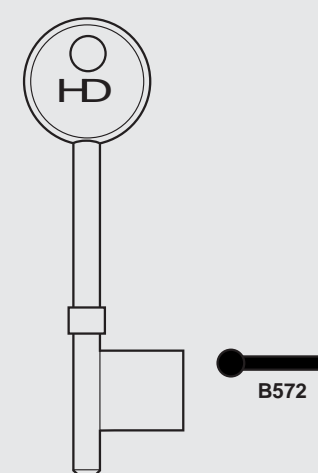

Material	Steel
Gauge	7
Finish	N/P

Spaceguard

**B593**

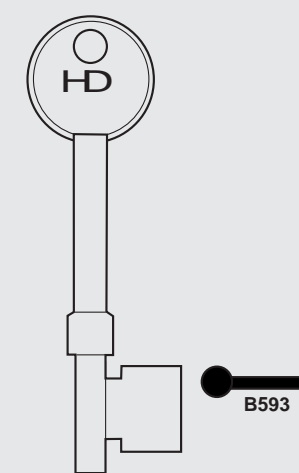

Material	Steel
Gauge	6.5
Finish	N/P

Union

**B440**

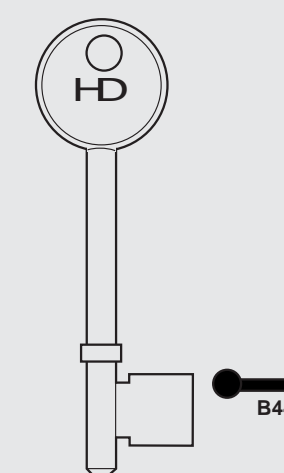

Material	Alloy
Gauge	5
Finish	Z/P

# Mortice Key Blanks

Union

**B436S**  
**B181**  
**B430**

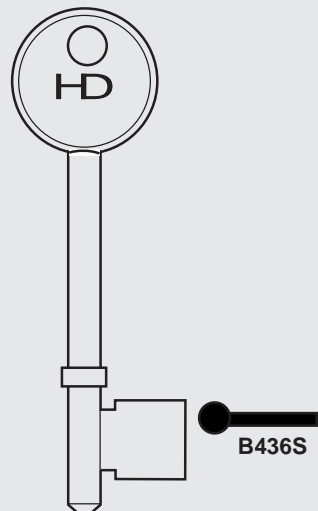

**B436S**

Material	Steel
Gauge	5
Finish	N/P

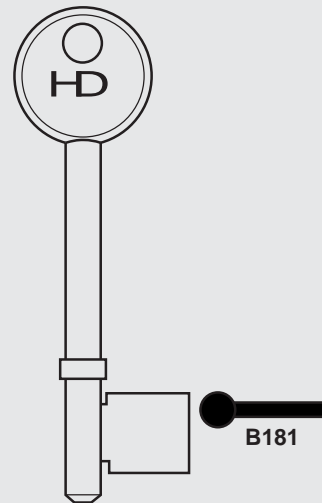

**B181**

Material	Steel
Gauge	5
Finish	N/P

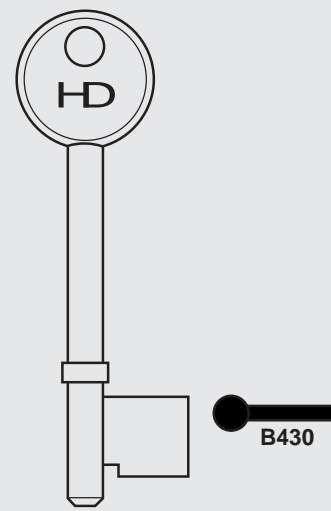

**B430**

Material	Steel
Gauge	5
Finish	N/P

Union

**B439/2**  
**B439/3**

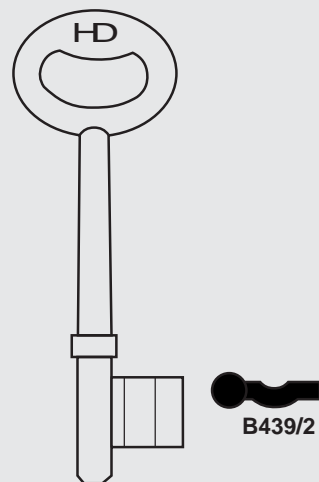

**B439/2**

Material	Alloy
Gauge	5.5
Finish	Z/P

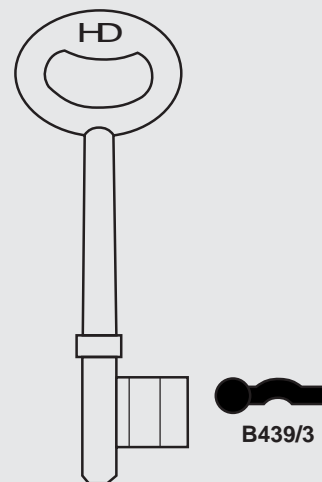

**B439/3**

Material	Alloy
Gauge	5.5
Finish	Z/P

Yale

**B447**

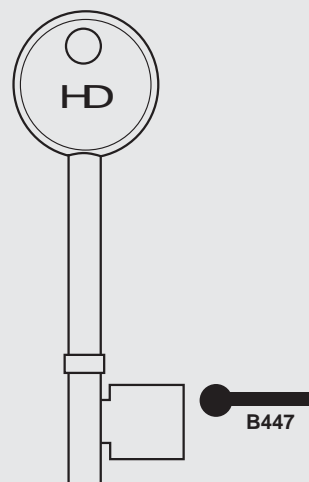

**B447**

Material	Alloy
Gauge	5.5
Finish	Z/P

Lever Mortice Blank

**183/5**  
**183/5.5**

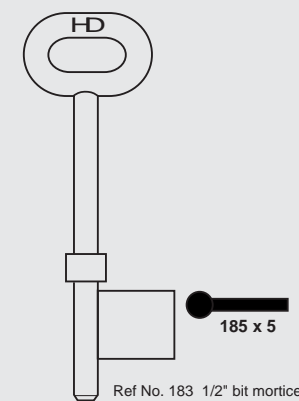

Ref No. 183 1/2" bit mortice

Material	Steel
Gauge	As Table
Finish	N/P

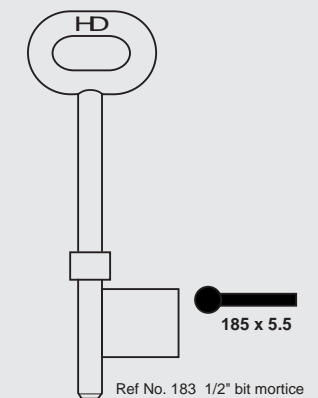

Ref No. 183 1/2" bit mortice

Material	Steel
Gauge	As Table
Finish	N/P

Lever Rim Blank

**130x6**

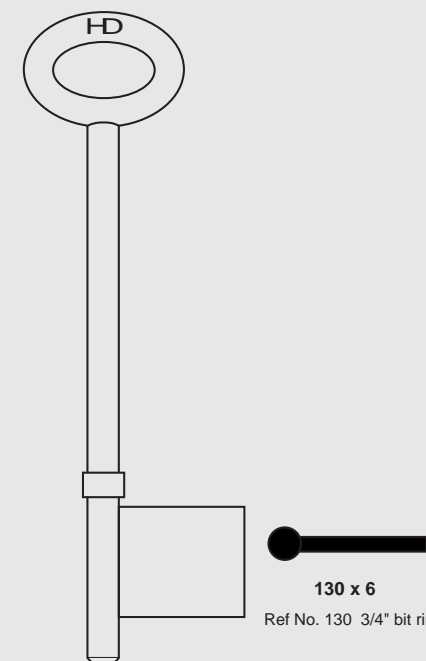

Ref No. 130 3/4" bit rim

Material	Steel
Gauge	As Table
Finish	N/P

Lever Rim Blank

**305x6**

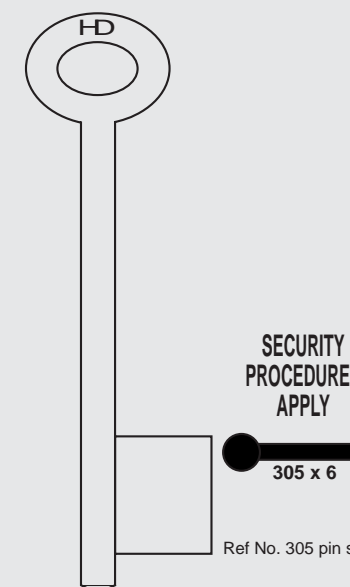

SECURITY  
PROCEDURES  
APPLY

305 x 6

Ref No. 305 pin safe 3/4" bit

Material	Steel
Gauge	As Table
Finish	N/P

FB Key Set

**FB.KS**



- 1 x FB1.Key Page 12
- 1 x FB2.Key Page 12
- 1 x FB4.Key Page 13
- 1 x LFB.Key Page 12
- 1 x LFB11.Key Page 12
- 1 x LFB14.Key Page 12

# Silicone & Adhesives



Full Architectural Ironmongery Catalogues  
available upon request

## Silicone

### NS.SC

A general purpose, silicone rubber sealant with fungicide. Suitable for most sealing jobs around the home.

WHT TR



## Multi-purpose gap-filling adhesive

### NS.SN

Solvent free, low odour, water clean-up, construction adhesive. Recommended for internal use only.



## Decorators Caulk

### NS.DC

A quick drying interior decorators filler. Adheres to most surfaces. (Not recommended for external use, for PVCU or in wet areas.) 310ml.

WHT



## Intumescent acoustic acrylic sealant and adhesive

### NS.FRA

Specially manufactured to form an acoustic and fire rated intumescent barrier in construction applications i.e. floor and ceiling joints etc. Solvent free. 4 hour fire rating. Conforms to BSEN 140 pt 3; BSEN 20140 & BS476 pt 20.



## Mitre kit

### NS.MK

A high strength bonding system comprising a cyanoacrylate adhesive with an aerosol activator. Pack includes: 1 tin of activator (200ml) and 1 bottle of HVC Superglue (50g).



## Sealant gun

### NS.SG

For use with cartridge based products. 400ml.

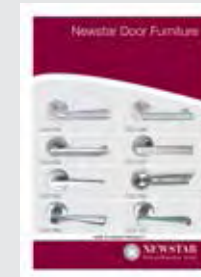

Door Furniture  
& Accessories

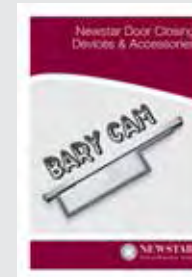

Door Closing Devices  
& Accessories



Hinges & Ancillary  
Devices

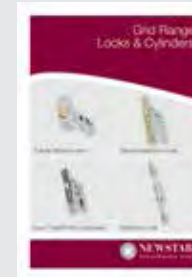

Grid Range Locks  
& Cylinders



Washroom, Bathroom  
& Disabled Fittings



National Key Scheme  
Locks & Keys

# Contacts

## Sales

T: (01474) 353111

F: (01474) 353911

E: sales@new-star.co.uk

W: new-star.co.uk





# NEWSTAR

Distributed by

**Newstar Door Controls Limited, Unit 2, Block A Lion Business Park, Dering Way, Gravesend, Kent DA12 2DN.**

**T:** (01474) 353111

**F:** (01474) 353911

**E:** [sales@new-star.co.uk](mailto:sales@new-star.co.uk)

**W:** [new-star.co.uk](http://new-star.co.uk)

All illustrations and dimensions given in this brochure are subject to change due to the continual refining and improving of the product range. Therefore we reserve the right to alter specification without prior notice. Any products purchased from this brochure are subject to our standard terms and conditions which are available upon request. January 2014. ● **impact** [www.impact-im.co.uk](http://www.impact-im.co.uk) (E2009/LU)