



Transom concealed  
door closer

# DORMA RTS 85

## Disappears into the frame

**Ideal for shopfitting. For both double and single action doors. Elegant, versatile, practical and quality assured.** The DORMA RTS 85 offers a solution for installations where door control must be provided without disturbing the aesthetic appearance of the door. The majority of preparation can be accomplished by the fabricator prior to installation,

leaving minimal on-site work. A complete line of accessories is available to accommodate virtually any door and frame configuration.



Quality assured manufacture to DIN ISO 9001, EN 29001, BS 5750  
certified and verified by BSI Quality Assurance  
Reg.-No. Q 6423, FM 10756

### Plus points

#### For the trade

- Just **one** body for all types of fixing.
- Low inventory costs and minimal stocking requirement thanks to unit packs for closer body and accessories.

#### For the fabricator

- Can be used for double action doors, or left and right hand single action doors.
- Installation and setting adjustment possible before fixing the doorset on site.
- No floor preparation necessary.
- Positive "zero" position for double action doors – easy to adjust.
- Comprehensive range of accessories.

#### For the architect/specifier

- Aesthetically impressive solution – especially with toughened glass doors.
- Ideal for shopfitting applications.

#### For the user

- No cluttering of door or floor appearance.
- Backcheck to prevent door contact with the frame.
- Smooth closing with adjustable closing speed.

Technical Data		RTS 85		
		EN 3	EN 4	EN 5
Closing force	Internal	●	–	–
	up to 950 mm	–	●	–
	and external 1100 mm	–	–	●
doors*				
Same model for double action doors, RH (ISO 5) and LH (ISO 6)		●	●	●
Closing speed variable by valve adjustment		●	●	●
Final closing speed variable by valve adjustment		●	●	●
Backcheck, progressive, mechanical		●	●	●
Backstop, mechanical		●	●	●
Hold-open	105°	○	○	○
	90°	○	○	○
Extended spindle	5 mm	○	○	○
	10 mm	○	○	○
Reduced pivot point for tempered glass doors (65 mm)		○	○	○
Weight in kg		4.7	4.8	4.9
Dimensions in mm	Length	323	323	323
	Width	90	90	90
	Height	38	38	38
Door closer tested to EN 1154		●	●	●

● Yes – No ○ Option

\* Max Door weight for floor pivot 8550–8557 90 kgs.  
8560 G 200 kgs.

RTS 85 and all related accessories have been successfully independently third party type tested and CE Marked to BS EN 1154.

Classification codes:

EN3 3 8 3 1 1 4  
EN4 3 8 4 1 1 4  
EN5 3 8 5 1 1 4

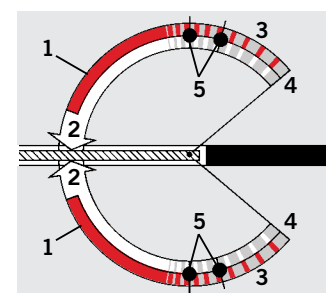
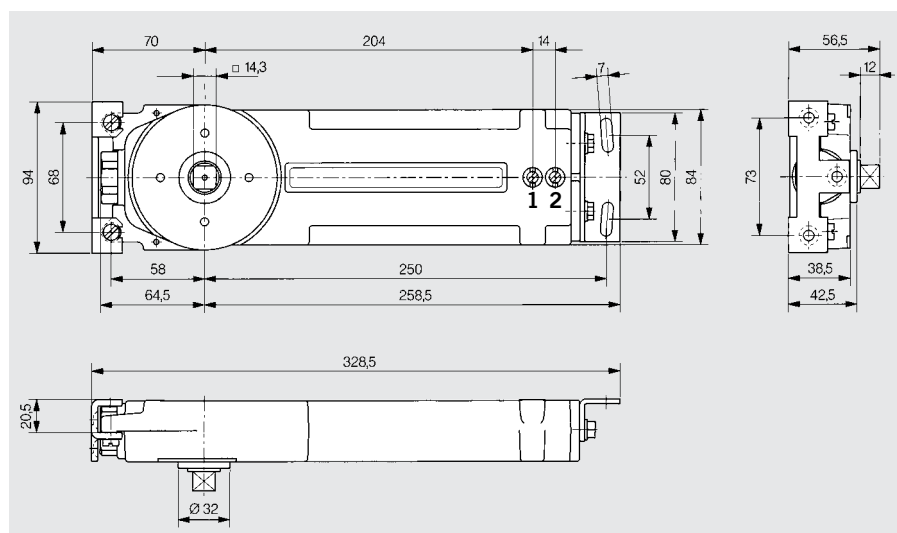

### Standard and optional functions

- 1 Fully controlled closing with adjustable speed
- 2 Adjustable final closing
- 3 Progressive mechanical backcheck
- 4 Mechanical backstop\*\*
- 5 Hold-open points – depending on model (optional) 105° or 90°

\*\* Door opening angle max. 130° on both sides; in the case of heavy doors which can be opened further, door stops must be used. In the case of single action doors, the opening angle may be reduced depending on the door design.

### Accessories for double action and centre pivoted single action doors (70 mm pivot point)

#### Side-load installation

Side-load installation is achieved by offering the door in the closed position, onto the floor pivot. The closer arm, fitted in the upper door rail, is connected to the spindle and secured with a clamping piece.

#### 1 Closer arm with arm channel

Art.-No. 8530  
for top rails with min. 15 mm channel depth and 38 mm width

#### 2 Universal floor pivot side load

Art.-No. 8550/1  
for bottom rails with channel depth of up to 50 mm. Floor portion of pivot is fitted directly to floor and adjustable in height.

#### 3 Universal threshold pivot set side load

Art.-No. 8554/6  
for bottom rails with channel depth of up to 50 mm. Floor clearance: 5 mm. Floor portion is fitted directly to threshold and adjustable in height.

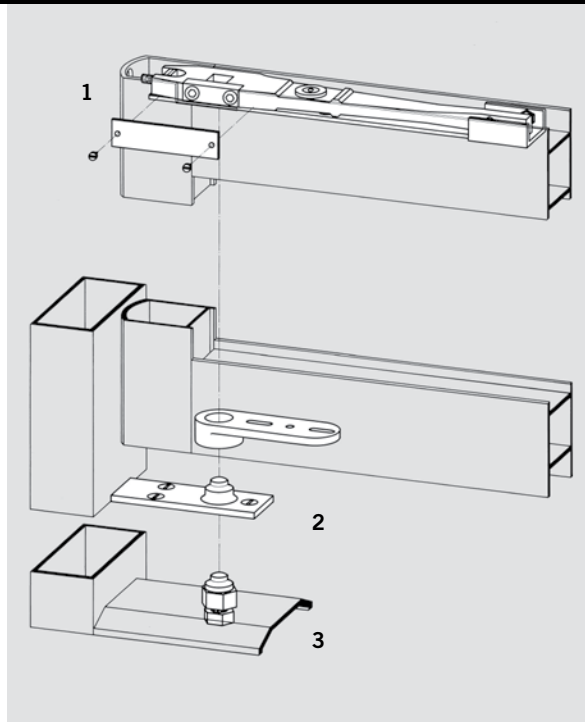

#### End-load installation

End-load installation is achieved by offering the door, in the open position, onto the floor pivot and spindle simultaneously. The floor pivot locks automatically, connection to spindle is secured with a clamping piece.

#### 1 Closer arm with arm channel

Art.-No. 8534  
for top rails with min. 21 mm channel depth and 35 mm width.

#### 2 Universal floor pivot set end load

Art.-No. 8552/3  
for bottom rails with channel depth of up to 50 mm. Floor portion of pivot is fitted directly to floor and is adjustable in height.

#### 3 Universal threshold pivot side end load

Art.-No. 8555/7  
for bottom rails with channel depth of up to 50 mm. Floor clearance: 5 mm. Floor portion is fitted directly to threshold and is height adjustable.

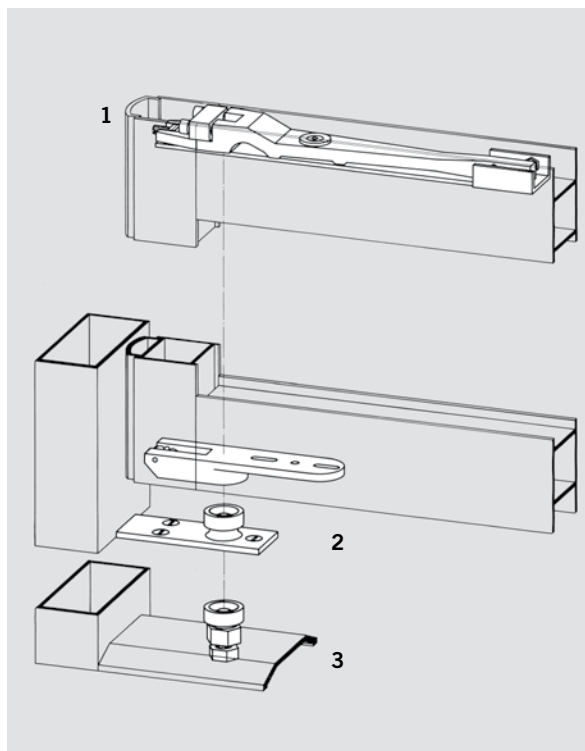

#### End load pinch free flat arm (K type)

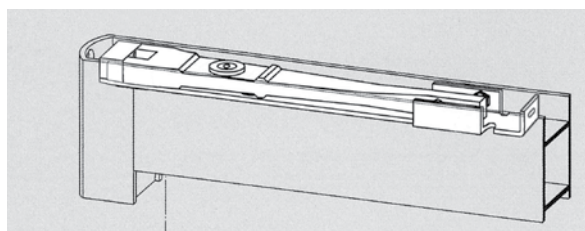

### Accessories for butt hung or offset pivoted single action doors

Single action doors hung on butt hinges or offset pivots can be connected to the closer with slide arm and channel assemblies. Please note that this application may reduce the maximum opening angle available on the door. Similarly, if a hold-open model has been selected, the hold-open point will be altered: eg instead of 105°, the position

will lie between 90° and 100°, depending on door thickness.

**Note:**

Maximum door opening with slide arm and channel assemblies –105°. Consult our Technical Service Department giving specific details for slide arm and channel assemblies. Drawings of door and frame

details must be submitted together with the pivot centre of the hinge.

**1 Slide arm and channel**  
Art.-No. 8510

**2 Weld-on extension**  
Art.-No. 8521  
For steel doors, 40 mm long (can be shortened), 38 mm dia.

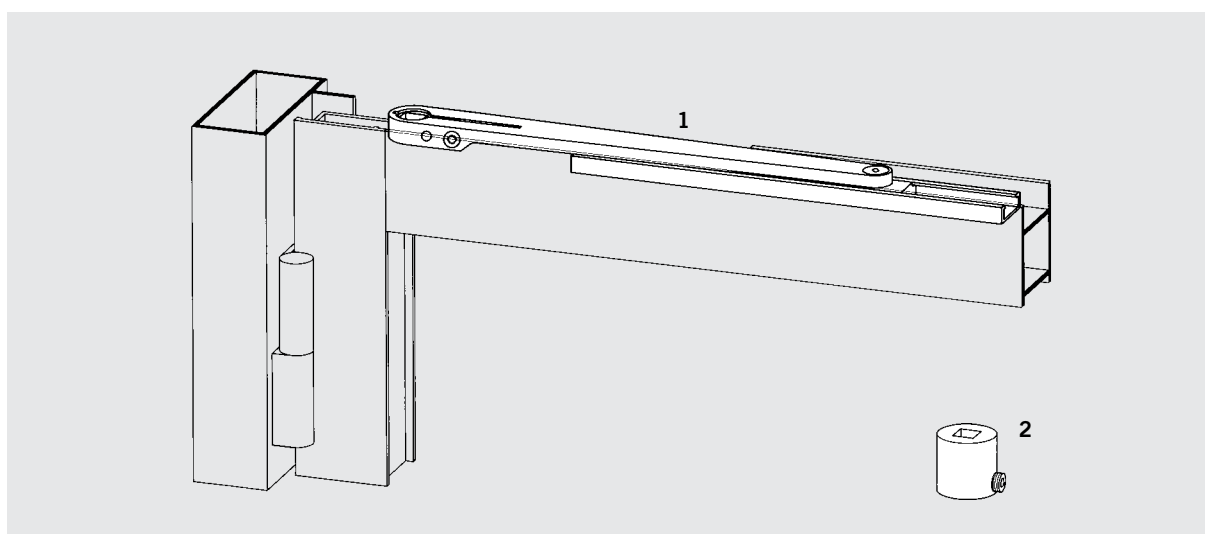

### Accessories for tempered glass doors (65 mm pivot point)

For tempered glass doors, the RTS 85 is used with a special fixing bracket, Art.-No. 8520 G, giving a 65 mm pivot point. The standard patch fittings can thus be used with appropriate inserts. (Patch fittings with insert available from DORMA Glass range of products).

**1 Fixing bracket**

Art.-No. 8520 G  
For fixing the DORMA RTS in the transom.

**2 Floor pivot bearing with flat-tapered spindle**

Art.-No. 8560 G  
With sealed roller bearing assembly, rust-protected, for max. door weights of 110 kg (if used without the transom concealed door closer, then 200 kg).

Special pivots also available with extended spindles of 5, 10 and 15 mm, and also for special environments (e.g. wet rooms) in stainless steel; Art.-No. 8560 GE (only available with standard spindle).

The floor pivot bearing combined with appropriate bottom straps from the accessories range for DORMA BTS floor springs is also suitable for aluminium, steel and timber doors.

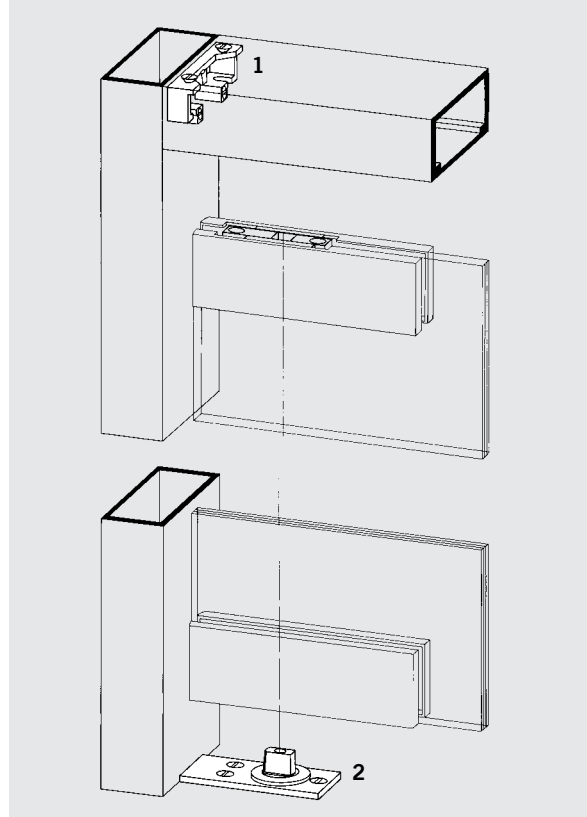



**DORMA RTS 85 for double and single action doors**

Door closer RTS 85	Standard model	Standard model with hold-open at 105°	Standard model with hold-open at 90°	with spindle insert 5 mm extended	with spindle insert 5 mm extended and hold-open at 105°	with spindle insert 5 mm extended and hold-open at 90°	with spindle insert 10 mm extended	with spindle insert 10 mm extended and hold-open at 105°	with spindle insert 10 mm extended and hold-open at 90°
EN 3	85311101	85313101	85312101	85311102	–	–	85311103	–	85312103
EN 4	85321101	85323101	85322101	85321102	85323102	85322102	85321103	–	85322103
EN 5	85331101	85333101	85332101	85331102	–	–	85331103	–	85332103
Dummy	2420000070	–	–	–	–	–	–	–	–

Accessories	closer arm with channel	Universal floor pivot set	Universal threshold pivot set	Closer arm with channel for single action doors	weld-on extensions
Side-load installation	85210005	85210022	85210024	85210001	85110001
End-load installation	85210009	85210021	85210023		
Pinch free	85210035	–	85210024		

**DORMA RTS 85 for tempered glass doors**

Accessories for glass doors	Floor pivot set	Floor pivot set 5 mm extended	Floor pivot set 10 mm extended	Floor pivot set 15 mm extended	Floor pivot set stainless steel
	65540000	85210025	85210026	85210027	85540059

**Specification text**

Transom concealed door closer with built-in cushion backcheck, adjustable closing speed and sweep range.

**Size**

- ☐ EN 3  
☐ EN 4  
☐ EN 5

**Model**

- ☐ For both single and double action doors (pivot point 70 mm)  
☐ For tempered glass doors (pivot point 65 mm)  
☐ Non hold-open  
☐ Hold-open at 105°  
☐ Hold-open at 90°  
☐ With spindle insert 5 mm extended  
☐ With spindle insert 10 mm extended  
☐ Closer arm  
 Art.-No. \_\_\_\_\_  
☐ Floor pivot set  
 Art.-No. \_\_\_\_\_

**Make:** DORMA RTS 85

**DORMA UK Limited**  
 Wilbury Way  
 Hitchin  
 Herts SG4 0AB  
 Tel. 01462 477600  
 Fax 01462 477601  
 E-mail:  
 hardware@dorma-uk.co.uk

www.dorma-uk.co.uk

**DORMA Ireland Limited**  
 PO Box 1050  
 Maynooth  
 Co. Kildare  
 Tel. 01 295 8280  
 Fax 01 295 8284  
 E-mail: dormadublin@dorma.ie

www.dorma.ie